

© Crown Copyright and database right 2012. Ordnance Survey 100019747.

Planning Application No 12/00276/F
 Site Address Westlegate House
 Scale 1:500



NORWICH
 City Council
 PLANNING SERVICES



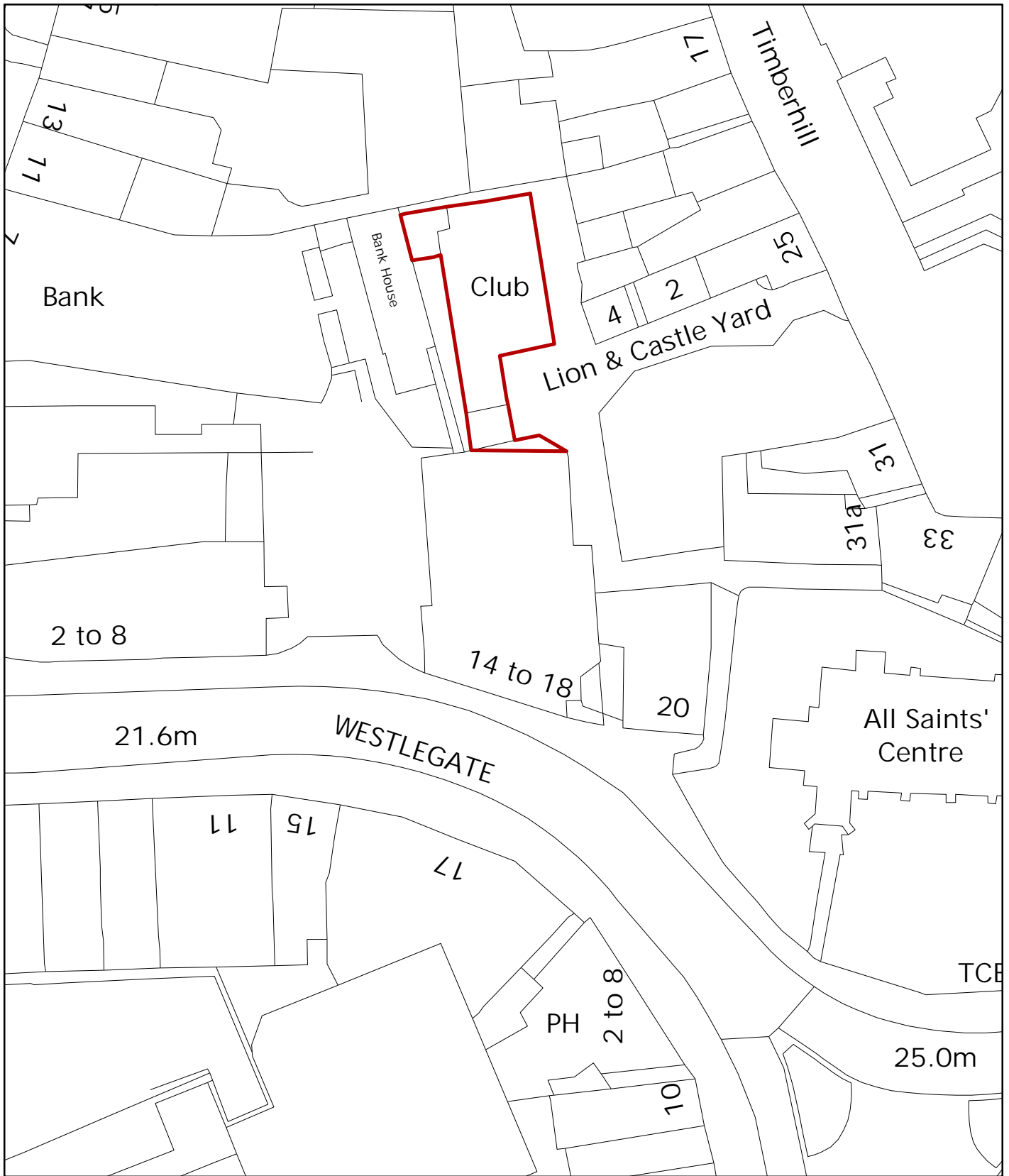

© Crown Copyright and database right 2012. Ordnance Survey 100019747.

Planning Application No 12/00319/C
 Site Address Westlegate House
 Scale 1:500



NORWICH
 City Council

PLANNING SERVICES



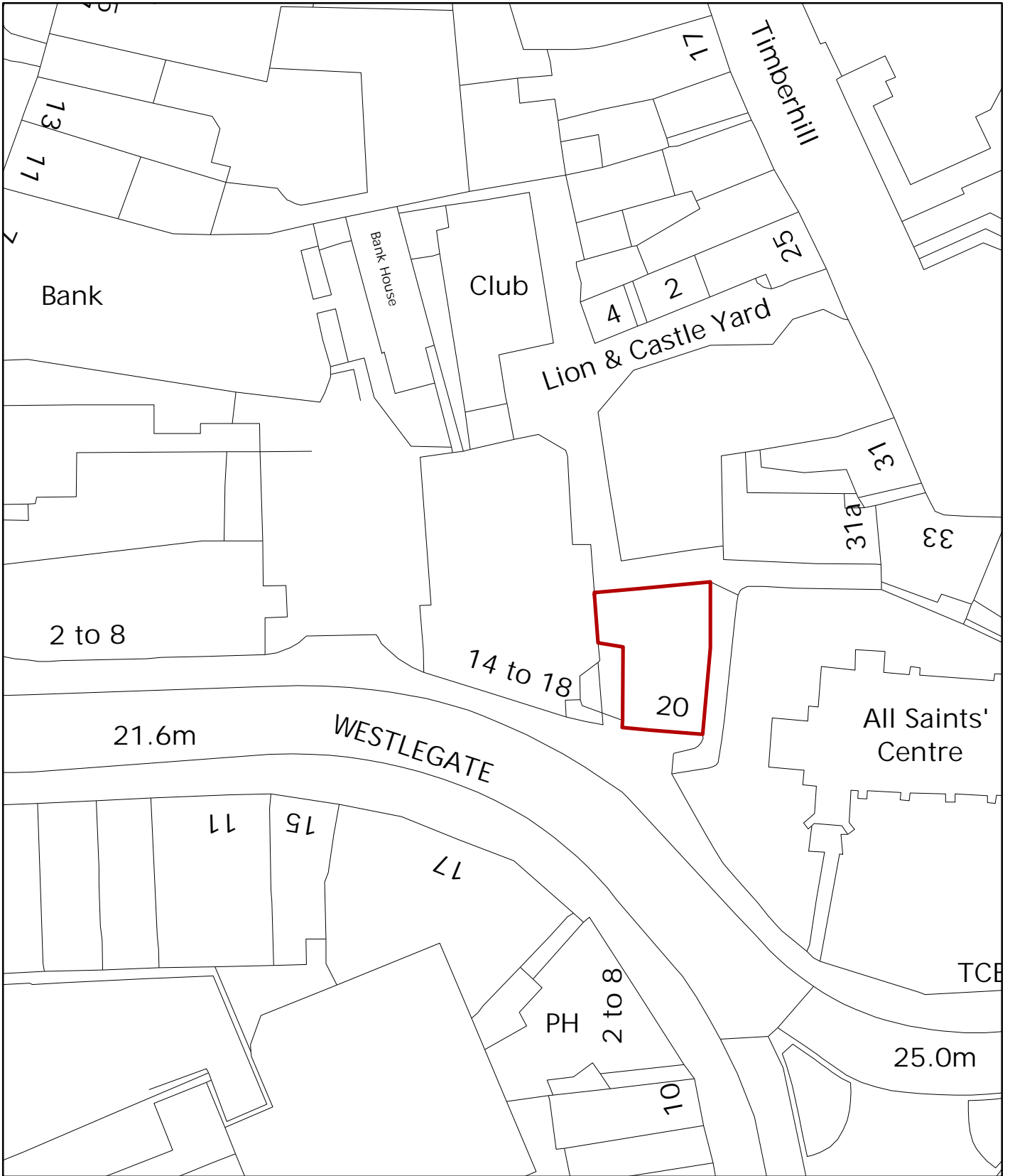

© Crown Copyright and database right 2012. Ordnance Survey 100019747.

Planning Application No 12/00277/L
 Site Address Westlegate House
 Scale 1:500



NORWICH
 City Council

PLANNING SERVICES



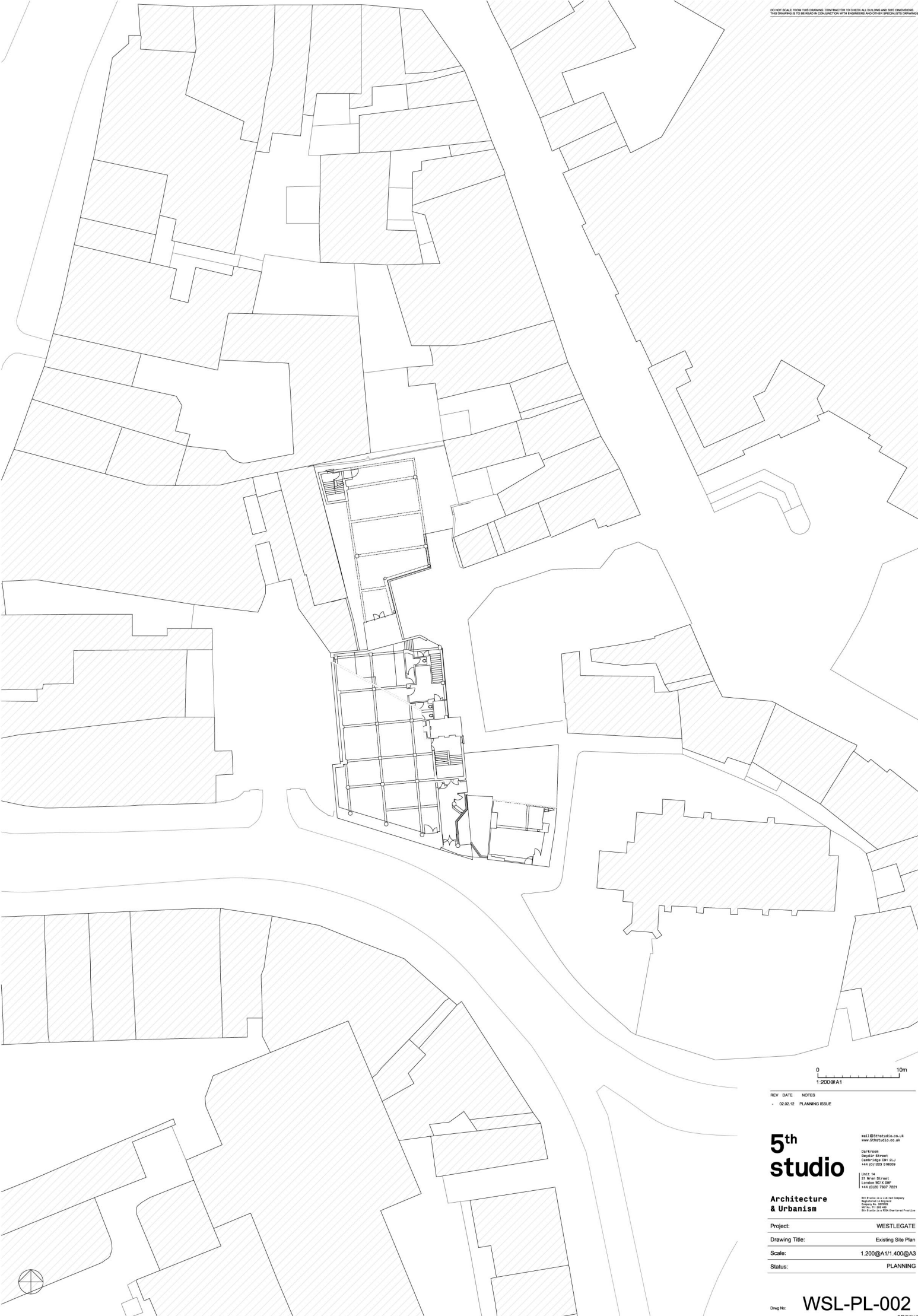

REV	DATE	NOTES
-	02.02.12	PLANNING ISSUE

5th studio

1411@5thstudio.co.uk
www.5thstudio.co.uk

5th FLOOR
5th FLOOR
CAMBRIDGE CITY BUILDING
+44 (0)1223 516009

10th FLOOR
10th FLOOR
21, MARK STREET
CAMBRIDGE WC1R 7EH
+44 (0)1223 7837 7221

Architecture & Urbanism

5th FLOOR is a LIMITED LIABILITY PARTNERSHIP
INCORPORATED IN ENGLAND
Company No. 0871219
VAT No. 251 251 251
5th FLOOR is a 5th Floor Partnership

Project:	WESTLEGATE
Drawing Title:	Existing Site Plan
Scale:	1:200@A1/1:400@A3
Status:	PLANNING

Drawg No: **WSL-PL-002**



CASTLE MALL

TIMBERHILL

LION & CASTLE YARD

27-29 TIMBERHILL

WESTLEGATE HOUSE

NO. 20 WESTLEGATE

ALL SAINTS CHURCH

WESTLEGATE

ALL SAINTS GREEN



REV	DATE	NOTES
02.05.12		PLANNING ISSUE
A	30.03.12	PLANNING REVISIONS

5th studio

mail@5thstudio.co.uk
www.5thstudio.co.uk

5th Studio
049617 217 ext 1
Castle Road, 101, 112, 113
+44 (0)1223 516000

Unit 14
14 West Street
London WC1E 6DF
+44 (0)20 7637 7221

5th Studio is a Limited Liability Partnership
Registered in England
Number 07120487
5th Studio is a RIBA Chartered Practice

Architecture & Urbanism

Project:	WESTLEGATE
Drawing Title:	Proposed Site Plan
Scale:	1:200@A1/1:400@A3
Status:	PLANNING

Draw No: **WSL-PL-102A**