



NORWICH City Council

Committee Name: Licensing sub

Committee Date: 17/06/2024

Report Title: Application for the grant of a premises Licence for Joys, 2A Sprowston Road, Norwich NR3 4QN

Portfolio: To be confirmed

Report from: Head of planning and regulatory services

Wards: Sewell

OPEN ITEM

Purpose

Members are asked, in accordance with the delegation of licensing functions contained in the Norwich City Council Statement of Licensing Policy (Licensing Act 2003), to consider the application for the grant of a premises licence in respect of Joys, 2A Sprowston Road, Norwich NR3 4QN following the receipt of relevant representation.

Recommendation:

It is recommended that members determine the application to grant the premises Licence in accordance with the:

- Licensing Act 2003 and subsequent regulations
- Guidance issued under Section 182 of the Licensing Act 2003; and
- Norwich City Council Statement of Licensing Policy

Policy Framework

The council has five corporate priorities, which are:

- An open and modern council
- A prosperous Norwich
- A fairer Norwich
- A climate responsive Norwich
- A future-proof Norwich

This report meets the 'A prosperous Norwich' and 'A fairer Norwich' corporate priorities.

Report Details

The application

1. The applicant is Mr Colin Shreeve and the DPS is to be Molly Riseborough (this was changed via an email received on 29 May 2024).
2. The application seeks to allow the licensable activities, times and opening hours as set out in the application form, which is attached at appendix A. This also includes the steps proposed to promote the licensing objectives (operating schedule).

Relevant representations

3. The responses from the Responsible Authorities are as follows:

Police – representation received (copy attached at appendix B)

Public Protection– no representations

Fire Officer – no representations

Planning Officer – no representations

Area Child Protection Committee – no representations

Trading Standards – no representations

Primary Care Trust – no representations

14 Local Residents – representation received (copies attached at appendix C)

Summary

4. In determining the application with a view to promoting the licensing objectives the sub-committee must give appropriate weight to:
 - the steps that are appropriate to promote the licensing objectives (i.e. the prevention of crime and disorder; public safety; the prevention of public nuisance; and the protection of children from harm);
 - the representations (including supporting information) presented by all the parties;
 - the guidance issued under Section 182 of the Licensing Act 2003 (national guidance); and
 - the council's own statement of licensing policy.

5. The Sub-Committee must take such of the following steps as it considers appropriate for the promotion of the licensing objectives:
 - Grant the application as asked;
 - Modify the conditions of the licence by altering or omitting or adding to them;
 - Reject the whole or part of the application;

6. The sub-committee is asked to note that it may not modify the conditions or reject the whole or part of the application merely because it considers it desirable to do so. It must actually be appropriate in order to promote the licensing objectives.

7. The representation received appears to relate to issues that fall under the licensing objectives.

Implications

Financial and Resources

Any decision to reduce or increase resources or alternatively increase income must be made within the context of the council's stated priorities, as set out in its Corporate Plan and Budget.

8. There are no proposals in this report that would reduce or increase resources.

Legal

9. In making their determination members must give appropriate regard to the following:
 - [Licensing Act 2003 and subsequent regulations](#)
 - [Guidance issued under Section 182 of the Licensing Act 2003](#); and
 - [Norwich City Council Statement of Licensing Policy](#)

Statutory Considerations

Consideration	Details of any implications and proposed measures to address:
Equality and Diversity	No implications, no proposed measures
Health, Social and Economic Impact	No implications, no proposed measures
Crime and Disorder	Norfolk Constabulary are a responsible authority under the legislation, no proposed measures
Children and Adults Safeguarding	Social Services and Children's Safeguarding Board are responsible authorities under the legislation, no proposed measures

Consideration	Details of any implications and proposed measures to address:
Environmental Impact	No implications, no proposed measures

Risk Management

Risk	Consequence	Controls Required
Legal	Risk of challenge to incorrectly made decision	Consideration of legislation and application information. Legal advisor to support members in making their decision.
Reputational risk to the council	If problems arise following a decision to grant or if a decision is made incorrectly	Legal advisor to support members in making their decision

Reasons for the decision/recommendation

10. It is recommended that members determine the application to grant the premises Licence in accordance with the:

- Licensing Act 2003 and subsequent regulations
- Guidance issued under Section 182 of the Licensing Act 2003; and
- Norwich City Council Statement of Licensing Policy

Background papers: None

Appendices:

- A – Application form
- B – Police representation
- C – Local residents' representation

Contact Officer: Public Protection Licensing Advisor

Name: Maxine Fuller

Telephone number: 01603 989400

Email address: licensing@norwich.gov.uk

RECEIVED ON
19 APR 2024
BST 04

Application for a premises licence to be granted under the Licensing Act 2003

Please read the following instructions first

Before completing this form please read the guidance notes at the end of the form. If you are completing this form by hand please write legibly in block capitals. In all cases ensure that your answers are inside the boxes and written in black ink. Use additional sheets if necessary.

You may wish to keep a copy of the completed form for your records.

I/We COLIN RICHARD SHREEVE

(Insert name(s) of applicant)

apply for a premises licence under section 17 of the Licensing Act 2003 for the premises described in Part 1 below (the premises) and I/we are making this application to you as the relevant licensing authority in accordance with section 12 of the Licensing Act 2003

Part 1 – Premises details

Postal address of premises or, if none, Ordnance Survey map reference and description			
2A SPROWSTON ROAD NORWICH NR3 4QN			
Post town		Postcode	
NORWICH		NR3 4QN	

RECEIVED
19 APR 2024
LICENSING OFFICE

Telephone number at premises (if any)	
Non-domestic rateable value of premises	£9600

Part 2 - Applicant details

Please state whether you are applying for a premises licence as **Please tick as appropriate**

a)	an individual or individuals *	<input checked="" type="checkbox"/>	please complete section (A)
b)	a person other than an individual *	<input type="checkbox"/>	
	i as a limited company/limited liability partnership	<input type="checkbox"/>	please complete section (B)
	ii as a partnership (other than limited liability)	<input type="checkbox"/>	please complete section (B)
	iii as an unincorporated association or	<input type="checkbox"/>	please complete section (B)
	iv other (for example a statutory corporation)	<input type="checkbox"/>	please complete section (B)
c)	a recognised club	<input type="checkbox"/>	please complete section (B)
d)	a charity	<input type="checkbox"/>	please complete section (B)

e)	the proprietor of an educational establishment		please complete section (B)
f)	a health service body		please complete section (B)
g)	a person who is registered under Part 2 of the Care Standards Act 2000 (c14) in respect of an independent hospital in Wales		please complete section (B)
ga)	a person who is registered under Chapter 2 of Part 1 of the Health and Social Care Act 2008 (within the meaning of that Part) in an independent hospital in England		please complete section (B)
h)	the chief officer of police of a police force in England and Wales		please complete section (B)

* If you are applying as a person described in (a) or (b) please confirm (by ticking yes to one box below):

- I am carrying on or proposing to carry on a business which involves the use of the premises for licensable activities; or
- I am making the application pursuant to a
- statutory function or
- a function discharged by virtue of Her Majesty's prerogative

(A) individual applicants (fill in as applicable)

<input checked="" type="radio"/> Mr	Mrs	Miss	Ms	Other Title (for example, Rev)
Surname SHREEVE		First names COLIN RICHARD		
Date of birth		am 18 years old or over	Please tick yes <input checked="" type="checkbox"/>	
Nationality BRITISH				
Current residential address if different from premises address				
Post town				
Daytime contact telephone number				
E-mail address (optional)				
Where applicable (if demonstrating a right to work via the Home Office online right to work checking service), the 'share code' provided to the applicant by that service (please see note 15 for information)				

Second individual applicant (if applicable)

Mr	Mrs	Miss	Ms	Other Title (for example, Rev)	
Surname			First names		
Date of birth over		I am 18 years old or		Please tick yes	
Nationality					
Current residential address if different from premises address					
Post town				Postcode	
Daytime contact telephone number					
E-mail address (optional)					
Where applicable (if demonstrating a right to work via the Home Office online right to work checking service), the 'share code' provided to the applicant by that service: (please see note 15 for information)					

(B) Other applicants

Please provide name and registered address of applicant in full. Where appropriate please give any registered number. In the case of a partnership or other joint venture (other than a body corporate), please give the name and address of each party concerned.

Name
Address
Registered number (where applicable)
Description of applicant (for example, partnership, company, unincorporated association etc.)
Telephone number (if any)

E-mail address (optional)

Part 3 Operating Schedule

When do you want the premises licence to start?

DD MM YYYY
2 8 0 5 2 0 2 4

If you wish the licence to be valid only for a limited period, when do you want it to end?

DD MM YYYY
[] [] [] [] [] [] [] []

Please give a general description of the premises (please read guidance note 1)
PREMISES IS SITUATED SPROWSTON ROAD. 45 FT LONG 19 FT WIDE TO BE USED AS POOL CLUB COMPRISING OF 5-6 POOL TABLES AND POSSIBLY SOME DART BOARDS IT WILL BE A MEMBERS CLUB WITH MEMBERSHIP CHARGED ANNUALLY. GUESTS WILL BE WELCOME BUT EXPECTED TO PAY A SMALL CHARGE.

If 5,000 or more people are expected to attend the premises at any one time, please state the number expected to attend.

[]

What licensable activities do you intend to carry on from the premises?

(please see sections 1 and 14 and Schedules 1 and 2 to the Licensing Act 2003)

Provision of regulated entertainment (please read guidance note 2)		Please tick all that apply
a)	plays (if ticking yes, fill in box A)	
b)	films (if ticking yes, fill in box B)	
c)	indoor sporting events (if ticking yes, fill in box C)	✓
d)	boxing or wrestling entertainment (if ticking yes, fill in box D)	
e)	live music (if ticking yes, fill in box E)	
f)	recorded music (if ticking yes, fill in box F)	
g)	performances of dance (if ticking yes, fill in box G)	
h)	anything of a similar description to that falling within (e), (f) or (g) (if ticking yes, fill in box H)	

<u>Provision of late night refreshment</u> (if ticking yes, fill in box I)	
<u>Supply of alcohol</u> (if ticking yes, fill in box J)	✓

In all cases complete boxes K, L and M

A

Plays Standard days and timings (please read guidance note 7)			Will the performance of a play take place indoors or outdoors or both – please tick (please read guidance note 3)	Indoors	
Day	Start	Finish		Outdoors	
				Both	
Mon			Please give further details here (please read guidance note 4)		
Tue					
Wed			State any seasonal variations for performing plays (please read guidance note 5)		
Thur					
Fri			Non standard timings. Where you intend to use the premises for the performance of plays at different times to those listed in the column on the left, please list (please read guidance note 6)		
Sat					
Sun					

B

Films Standard days and timings (please read guidance note 7)			<u>Will the exhibition of films take place indoors or outdoors or both – please tick</u> (please read guidance note 3)	Indoors	
Day	Start	Finish		Outdoors	
Mon				Both	
Mon			<u>Please give further details here</u> (please read guidance note 4)		
Tue					
Wed			<u>State any seasonal variations for the exhibition of films</u> (please read guidance note 5)		
Thur					
Fri			<u>Non standard timings. Where you intend to use the premises for the exhibition of films at different times to those listed in the column on the left, please list</u> (please read guidance note 6)		
Sat					
Sun					

C

Indoor sporting events Standard days and timings (please read guidance note 7)			Please give further details (please read guidance note 4)
Day	Start	Finish	
Mon	10.30 AM	11.00 PM	
Tue	10.30 AM	11 PM	
Wed	10.30 AM	11 PM	State any seasonal variations for indoor sporting events (please read guidance note 5)
Thur	10.30	11 PM	
Fri	10.30	12 AM	Non standard timings. Where you intend to use the premises for indoor sporting events at different times to those listed in the column on the left, please list (please read guidance note 6)
Sat	10.30	12 AM	
Sun	10.30	11 PM	

D

Boxing or wrestling entertainments Standard days and timings (please read guidance note 7)			Will the boxing or wrestling entertainment take place indoors or outdoors or both – please tick (please read guidance note 3)	Indoors	
				Outdoors	
				Both	
Day	Start	Finish			
Mon			Please give further details here (please read guidance note 4)		
Tue					
Wed			State any seasonal variations for boxing or wrestling entertainment (please read guidance note 5)		
Thur					
Fri			Non standard timings. Where you intend to use the premises for boxing or wrestling entertainment at different times to those listed in the column on the left, please list (please read guidance note 6)		
Sat					
Sun					

E

Live music Standard days and timings (please read guidance note 7)			Will the performance of live music take place indoors or outdoors or both – please tick (please read guidance note 3)	Indoors	
				Outdoors	
Day	Start	Finish		Both	
Mon				Please give further details here (please read guidance note 4)	
Tue					
Wed			State any seasonal variations for the performance of live music (please read guidance note 5)		
Thur					
Fri			Non standard timings. Where you intend to use the premises for the performance of live music at different times to those listed in the column on the left, please list (please read guidance note 6)		
Sat					
Sun					

F

Recorded music Standard days and timings (please read guidance note 7)			Will the playing of recorded music take <u>place indoors or outdoors or both –</u> please tick (please read guidance note 3)	Indoors	
Day	Start	Finis h		Outdoors	
				Both	
Mon			Please give further details here (please read guidance note 4)		
Tue					
Wed			State any seasonal variations for the playing of recorded music (please read guidance note 5)		
Thur					
Fri			Non standard timings. Where you intend to use the premises for the playing of recorded music at different times to those listed in the column on the left, please list (please read guidance note 6)		
Sat					
Sun					

G

Performances of dance Standard days and timings (please read guidance note 7)			Will the performance of dance take place indoors or outdoors or both – please tick (please read guidance note 3)	Indoors	
				Outdoors	
Day	Start	Finish		Both	
Mon			Please give further details here (please read guidance note 4)		
Tue					
Wed			State any seasonal variations for the performance of dance (please read guidance note 5)		
Thur					
Fri			Non standard timings. Where you intend to use the premises for the performance of dance at different times to those listed in the column on the left, please list (please read guidance note 6)		
Sat					
Sun					

H

Anything of a similar description to that falling within (e), (f) or (g) Standard days and timings (please read guidance note 7)			Please give a description of the type of entertainment you will be providing		
Day	Start	Finish	<u>Will this entertainment take place indoors or outdoors or both – please tick</u> (please read guidance note 3)	Indoors	
Mon				Outdoors	
				Both	
Tue			<u>Please give further details here</u> (please read guidance note 4)		
Wed					
Thur			<u>State any seasonal variations for entertainment of a similar description to that falling within (e), (f) or (g)</u> (please read guidance note 5)		
Fri					
Sat			<u>Non standard timings. Where you intend to use the premises for the entertainment of a similar description to that falling within (e), (f) or (g) at different times to those listed in the column on the left, please list</u> (please read guidance note 6)		
Sun					

Late night refreshment Standard days and timings (please read guidance note 7)			Will the provision of late night refreshment take place indoors or outdoors or both – please tick (please read guidance note 3)	Indoors	
				Outdoors	
Both					
Day	Start	Finish			
Mon			Please give further details here (please read guidance note 4)		
Tue					
Wed			State any seasonal variations for the provision of late night refreshment (please read guidance note 5)		
Thur					
Fri			Non standard timings. Where you intend to use the premises for the provision of late night refreshment at different times, to those listed in the column on the left, please list (please read guidance note 6)		
Sat					
Sun					

J

Supply of alcohol Standard days and timings (please read guidance note 7)			Will the supply of alcohol be for consumption – please tick (please read guidance note 8)	On the premises	<input checked="" type="checkbox"/>
				Off the premises	<input type="checkbox"/>
				Both	<input type="checkbox"/>
Day	Start	Finish	State any seasonal variations for the supply of alcohol (please read guidance note 5)		
Mon	11 Am	11 Pm			
Tue	11 Am	11 Pm			
Wed	11 Am	11 Pm			
Thur	11 Am	11 pm			
Fri	11 Am	12 Am			
Sat	11 Am	12 Am			
Sun	11 Am	11 Pm			
			Non standard timings. Where you intend to use the premises for the supply of alcohol at different times to those listed in the column on the left, please list (please read guidance note 6)		

State the name and details of the individual whom you wish to specify on the licence as designated premises supervisor (Please see declaration about the entitlement to work in the checklist at the end of the form):

Name	COLIN RICHARD SHREEVE	
Date of birth		
Address		
Postcode		
Personal		
Issuing li		

K

Please highlight any adult entertainment or services, activities, other entertainment or matters ancillary to the use of the premises that may give rise to concern in respect of children (please read guidance note 9).

L

Hours premises are open to the public Standard days and timings (please read guidance note 7)			State any seasonal variations (please read guidance note 5)
Day	Start	Finish	
Mon	10.30 AM	11 PM	
Tue	10.30 AM	11 PM	
Wed	10.30	11 PM	
Thur	10.30	11 PM	
Fri	10.30	12 AM	
Sat	10.30	12 AM	
Sun	10.30	11 PM	

M

Describe the steps you intend to take to promote the four licensing objectives:

a) General – all four licensing objectives (b, c, d and e) (please read guidance note 10)

b) The prevention of crime and disorder

EXCESSIVE DRINKING WONT BE TOLERATED.
 SUBSTANCE ABUSE WONT BE TOLERATED.
 PROVISION OF CCTV.

c) Public safety

CCTV
 NO MORE THAN 30 MEMBERS IN AT ON-TIME

d) The prevention of public nuisance

BACKGROUND MUSIC KEPT TO LOW LEVEL
 CUSTOMERS ENCOURAGED NOT TO HAIRER OUTSIDE
 PREMISES.

e) The protection of children from harm

ALL UNDER SIXTEEN TO BE ACCOMPANIED BY
 ADULT.
 NO CHILDREN AFTER 8.30 PM.

Checklist:

Please tick to indicate agreement

<input type="checkbox"/>	I have made or enclosed payment of the fee.	<input checked="" type="checkbox"/>
<input type="checkbox"/>	I have enclosed the plan of the premises.	<input checked="" type="checkbox"/>
<input type="checkbox"/>	I have sent copies of this application and the plan to responsible authorities and others where applicable.	<input checked="" type="checkbox"/>
<input type="checkbox"/>	I have enclosed the consent form completed by the individual I wish to be designated premises supervisor, if applicable.	<input checked="" type="checkbox"/>

• I understand that I must now advertise my application.	✓
• I understand that if I do not comply with the above requirements my application will be rejected.	✓
• [Applicable to all individual applicants, including those in a partnership which is not a limited liability partnership, but not companies or limited liability partnerships] I have included documents demonstrating my entitlement to work in the United Kingdom or my share code issued by the Home Office online right to work checking service (please read note 15).	✓

It is an offence, under Section 158 of the Licensing Act 2003, to make a false statement in or in connection with this application. Those who make a false statement may be liable on summary conviction to a fine of any amount.

It is an offence under Section 24b of the Immigration Act 1971 for a person to work when they know, or have reasonable cause to believe, that they are disqualified from doing so by reason of their immigration status. Those who employ an adult without leave or who is subject to conditions as to employment will be liable to a civil penalty under section 15 of the Immigration, Asylum and Nationality Act 2006 and pursuant to Section 21 of the same act, will be committing an offence where they do so in the knowledge, or with reasonable cause to believe, that the employee is disqualified.

Part 4 – Signatures (please read guidance note 11)

Signature of applicant or applicant’s solicitor or other duly authorised agent (see guidance note 12). **If signing on behalf of the applicant, please state in what capacity.**

Declaration	<ul style="list-style-type: none"> • [Applicable to individual applicants only, including those in a partnership which is not a limited liability partnership] I understand I am not entitled to be issued with a licence if I do not have the entitlement to live and work in the UK (or if I am subject to a condition preventing me from doing work relating to the carrying on of a licensable activity) and that my licence will become invalid if I cease to be entitled to live and work in the UK (please read guidance note 15). • The DPS named in this application form is entitled to work in the UK (and is not subject to conditions preventing him or her from doing work relating to a licensable activity) and I have seen a copy of his or her proof of entitlement to work, or have conducted an online right to work check using the Home Office online right to work checking service which confirmed their right to work (please see note 15)
Signature	[Redacted]
Date	18.04.2024
Capacity	APPLICANT.

For joint applications, signature of 2nd applicant or 2nd applicant’s solicitor or other authorised agent (please read guidance note 13). **If signing on behalf of the applicant, please state in what capacity.**

Signature	
-----------	--

Date			
Capacity			
Contact name (where not previously given) and postal address for correspondence associated with this application (please read guidance note 14)			
Post town		Postcode	
Telephone number (if any)			
If you would prefer us to correspond with you by e-mail, your e-mail address (optional)			

Notes for Guidance

1. Describe the premises, for example the type of premises, its general situation and layout and any other information which could be relevant to the licensing objectives. Where your application includes off-supplies of alcohol and you intend to provide a place for consumption of these off-supplies, you must include a description of where the place will be and its proximity to the premises.
2. In terms of specific regulated entertainments please note that:
 - Plays: no licence is required for performances between 08:00 and 23.00 on any day, provided that the audience does not exceed 500.
 - Films: no licence is required for 'not-for-profit' film exhibition held in community premises between 08.00 and 23.00 on any day provided that the audience does not exceed 500 and the organiser (a) gets consent to the screening from a person who is responsible for the premises; and (b) ensures that each such screening abides by age classification ratings.
 - Indoor sporting events: no licence is required for performances between 08.00 and 23.00 on any day, provided that the audience does not exceed 1000.
 - Boxing or Wrestling Entertainment: no licence is required for a contest, exhibition or display of Greco-Roman wrestling, or freestyle wrestling between 08.00 and 23.00 on any day, provided that the audience does not exceed 1000. Combined fighting sports – defined as a contest, exhibition or display which combines boxing or wrestling with one or more martial arts – are licensable as a boxing or wrestling entertainment rather than an indoor sporting event.
 - Live music: no licence permission is required for:

Diagram 2A Sprawston Road

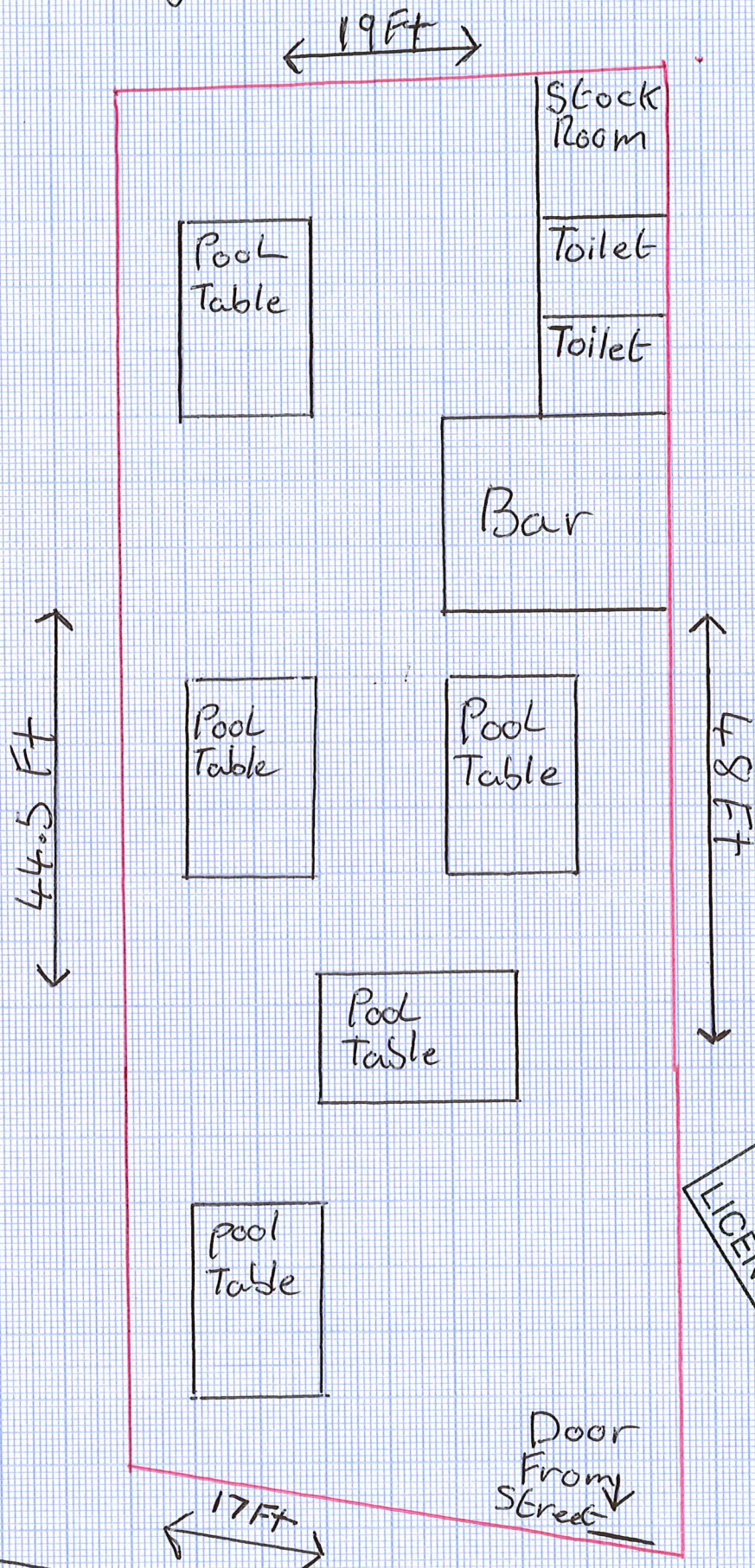

Sprawston Road





NORFOLK

CONSTABULARY

Our Priority is You

Licensing Team
Norwich City Council
St Peters Street
Norwich
NR2 1NN

Monday 20th May 2024

The Licensing Team

Building 8,
Norfolk Police Headquarters
Wymondham
Norfolk NR18 0WW

Tel: 01603 276020

Email: licensingteam@norfolk.police.uk

Dear Sir/Madam

www.norfolk.police.uk
Non-Emergency Tel: 101

I can confirm that Norfolk Constabulary has been consulted on the application for a new premises licence for 2A Sprowston Road Norwich.

The applicant is Colin Shreeve, and this application is to allow for indoor sporting events with the sale of alcohol for consumption on premises from 10:30am -Midnight Friday and Saturdays and 11am-11pm Sunday, Monday-Thursdays.

Following discussions with the applicant, I understand that the applicant is intending on withdrawing himself as DPS and nominating a family member instead. This family member will be working at the premises and a further DPS application will take place in due course.

The intention is to operate as a member pool club. In order to promote the licensing objectives, I would request that there are the following additions to the licence:

- **CCTV to be in operation at the premises. CCTV Cameras to record the main public areas of the premises and immediate outside. CCTV footage to record for a minimum of 28 days and be available to Police or Licensing Authority on request.**
- **There will always be one member of staff on duty who are conversant with the CCTV system when the premises are open for licensable activity.**
- **Staff will be trained in relation to the sale of alcohol. Training records will be kept at the premises and available to Police or Licensing Authority on request.**
- **Patrons will be prevented from taking open vessels of alcohol off the premises.**
- **The premises will operate a membership scheme.**
- **No person under the age of 18 will be permitted on the premises after 2030hrs.**
- **Signage will be on display reminding patrons to respect the neighbours.**

- **An incident log shall be kept at the premises and made available on request to an authorised officer of the Council or the Police, to include the following:-**
 - a) **All crimes reported to the venue**
 - b) **All complaints received.**
 - c) **All ejections of patrons**
 - d) **Any incidents of disorder**
 - e) **Seizure of drugs or offensive weapons**
 - f) **Any faults in the CCTV system**
 - g) **Any refusal of sale of alcohol.**

With the change to the DPS and additional conditions added to the Premises Licence, there are no Police objections.

Yours faithfully,

Michelle Bartram
Licensing Officer

Fuller, Maxine

From: autoreponse@norwich.gov.uk
 Sent: 30 May 2024 16:45
 To: LICENSING
 Subject: Online licensing representation form received

Norwich City Council

Licensing Authority

Licensing Act 2003

Statement of support or objection to an application for a premises licence

Your name/organisation name/name of body you represent	Sarah Gann
Postal address	23 Sprowston Road, Norwich, NR3 4QL
Email address	
Contact telephone number	
What type of licencing are you supporting or objecting to?	Premises licence - alcohol and entertainment
Are you supporting an application or objecting to one?	Objecting to a licence
Address of the premises you wish to object to	2A Sprowston Road Norwich NR3 4QN

Your support or objection must relate to one of the four licensing objectives

Please give details of your support/objection in relation to at least one of the four licensing objectives	<p>TO PREVENT CRIME & DISORDER: We have already had trouble with Class A drug dealing in this vicinity – and it's a possibility that this premises could increase the likelihood of drug use and dealing in the area. Recently, numbers of cars in the area have been vandalised. An establishment that is encouraging drinking all day from morning to late evening, 7 days a week, has the potential to increase crime and disorder locally, including vandalism to vehicles and property break-ins & theft. As a result of both daytime drinking and the late night sale of alcohol at the premises on a daily basis, there is the real likelihood of an increase in anti-social behaviour and crime around our homes, such as littering (not least cigarette butts and vapes), vandalism, and even aggressive behaviour and violence. PUBLIC SAFETY: Because the premises is situated directly on the public highway, groups of people from the club –</p>
--	--

	<p>many certainly having been drinking – will undoubtedly be milling about outside on the pavement, smoking and vaping. I live on my own directly opposite the premises, and can imagine there will be times when this could feel intimidating, even threatening. This is a residential area, with many families. This is an entirely inappropriate proposal in terms of public safety in relation to this area. Sprowston Road is a main thoroughfare to and from the city, and there are many pedestrians walking past the premises. Pedestrians are going to be forced to walk out onto the road to get by, creating a public safety hazard from passing traffic (although it's 20mph, vehicles frequently speed). There is also potentially a risk to patrons of the club of a traffic accident when leaving the club (especially if some may be inebriated). TO PREVENT PUBLIC NUISANCE: Living directly opposite, I will undoubtedly experience an increase in noise disturbance and nuisance from customers (many of whom will have been drinking) entering and leaving the premises up to 11pm 5 days a week, and midnight Fridays and Saturdays; and potentially from the playing of music at the premises. Parking is already a big problem in the area and this will be further exacerbated by some patrons who will undoubtedly drive to the club. TO PROTECT CHILDREN FROM HARM: I would be particularly concerned about how the granting of this license might adversely affect all of our day-to-day living experiences, our homes and the local area. This is a residential area, with many families & children living here. There will be drinking during the day – and likely increased evidence of inebriation - and smoking and vaping out on the street, which could be frightening and harmful to children (including those coming & going to local schools, both primary and secondary), particularly if there is aggressive behaviour being exhibited. There could also be the possibility of drug dealing, which children and young people could also be exposed to. There is also the potential for increased risk of harm to children having to step into the road to avoid patrons on the pavement outside the premises.</p>		
<p>Please suggest any conditions which would alleviate your concerns</p>	<p>None</p>		
<p>:</p>			
<p>Full name:</p>	<p>Sarah Gann</p>	<p>Date:</p>	<p>2024-05-30</p>

LICENSING

From: Leanne Botwright <[REDACTED]>
Sent: 27 May 2024 11:42
To: LICENSING
Subject: Object to licence request Joys - 2 May 2024

External Email: Be cautious about the sender email address, attachments and links. If uncertain please delete the email.

To whom it may concern,

I hope this message finds you well. I am writing to formally object to the licence application for Joys - 2 May 2024, proposed to be open 7 days a week in 2A Sprowston Road.

As a resident of this community, I have several concerns regarding this application:

Noise Pollution: The operation of a licensed pool/darts bar seven days a week is likely to generate significant noise, especially during late hours. This will undoubtedly disrupt the peace and quiet that residents currently enjoy, particularly during night time.

Safety and Security: An establishment serving alcohol daily can potentially lead to increased instances of anti-social behavior and crime. This raises concerns about the safety of residents, especially families with young children and elderly individuals living in the vicinity.

Traffic and Parking Issues: The influx of patrons to the bar is expected to exacerbate existing traffic congestion and create parking difficulties. This will inconvenience residents and could lead to dangerous situations on our roads.

Impact on Local Environment: The increased footfall and vehicular traffic will likely result in littering and environmental degradation, affecting the overall cleanliness and appearance of our neighbourhood.

Community Character: The presence of such a business operating daily could alter the character of our residential area, potentially deterring families and individuals who value a quiet and community-focused living environment.

I respectfully urge you to consider these points and the broader implications for our community. The proposed licence, in my view, does not align with the best interests of local residents and the quality of life we currently enjoy.

Thank you for your attention to this matter. I trust that the licensing committee will give due consideration to these valid concerns.

Yours sincerely,

Leanne Botwright

Fuller, Maxine

From: autoresponse@norwich.gov.uk
Sent: 08 May 2024 12:01
To: LICENSING
Subject: Online licensing representation form received

Norwich City Council

Licensing Authority

Licensing Act 2003

Statement of support or objection to an application for a premises licence

Your name/organisation name/name of body you represent	Abby Kidd
Postal address	10 Sprowston Road, Norwich, NR3 4QN
Email address	
Contact telephone number	
What type of licencing are you supporting or objecting to?	Premises licence - alcohol and entertainment
Are you supporting an application or objecting to one?	Objecting to a licence
Address of the premises you wish to object to	2A Sprowston Road, Norwich NR3 4QN

Your support or objection must relate to one of the four licensing objectives

Please give details of your support/objection in relation to at least one of the four licensing objectives	<p>Having thoroughly read the application on the Norwich City Council website, my objections are based on my concerns that the applicant has not fully understood and addressed the steps that they intend to take to promote the four licensing objectives, and therefore, they have not given diligent consideration to the extent of the negative impact this licensed premises could have on residents in the Sprowston Road area.</p> <p>The applicant has used just 48 words to outline how they will promote all four licensing objectives, which in my view is paltry and does not constitute a full acknowledgement of the steps that necessitate being taken to promote these objectives and protect the local area and community. To further illustrate this, on page 4 of the application, the applicant has not identified recorded music as one of the licensable activities they intend to carry on from the premises. In contradiction,</p>
---	---

however, on page 16, the applicant states that recorded music will be played. Does the applicant intend to play music or not? How exactly does the applicant intend on ensuring that music will be 'low-level', especially late at night so as not to disturb residents? In addition, on pages 15-6, the applicant has left the general steps they intend to take to promote the four licensing objectives entirely blank, again demonstrating a lack of rigorous consideration for the four licensing objectives as a whole. On page 16, the applicant states that excessive drinking and substance abuse 'won't be tolerated', but how exactly will these not be tolerated? What are the steps that the applicant will take to ensure this prevention of crime and disorder? The mention of 'CCTV' is insufficient. In terms of public safety and nuisance, how does the applicant intend to ensure that there are 'no more than 30 members on site' at any given time? How does the applicant intend to encourage inebriated patrons not to 'loiter' outside the premises in order to prevent public nuisance? How exactly will the applicant ensure that under 16's on the premises are clearly identified so as not to run the risk of serving them alcohol, thus putting them at risk of harm? There is no consideration of procedure to protect residents, nor patrons and employees, throughout the entire application. I am foremost concerned that the granting of this license will increase the possibility of public nuisance and crime and disorder for the many dwellings nearby, including my own. As aforementioned, I am especially apprehensive about noise nuisance, both from the music the applicant intends to play at the premises for over 12-hours a day 7-days a week and from patrons as they enter and exit the premises. For example, from what I can ascertain, patrons will be expected to loiter outside the front of the premises in the street to smoke/vape, which may not only result in an increase in litter in the form of cigarette butts and vape paraphernalia, but may also result in inebriated patrons taking alcohol served in glass vessels outside into the street that run the risk of being broken. This loitering could extend to neighbouring properties and may increase the risk of damage to said properties by inebriated patrons. Moreover, the sale of alcohol and on a late night basis encourages drinking culture, which in turn, could lead to an increase in violent crime in the immediate area. The thought of such disruptive incidents occurring so closely to my dwelling potentially on a daily basis is deeply concerning, and frankly, unacceptable. Furthermore, there are already a number of premises licensed to sell alcohol in the locality, (The Stanley, Danomey's, The Brewery Tap, The Prince of Denmark, Urban Bull Lounge, The Artichoke, The Marlborough Arms, The Cottage, The Malt and Mardle, and The King's Head). Several of these venues already offer indoor sports such as pool, bar billiards, and darts. This is all without mention of Riley's Sports Bar, located on nearby Magdalen Street, which not only serves alcohol, but also has over 20 snooker/pool tables and a number of dart boards. Therefore, I would consider there to be more than sufficient licensed premises offering indoor sports within the area. The granting of this premises license will also see an increase of visitor parking on Sprowston Road and the surrounding streets, which will not only pose a risk to public safety but also cause public nuisance. Parking on Sprowston Road has already worsened since the development of the larger building in which 2A Sprowston Road is situated, with employees and patrons of other new businesses frequently parking in spaces that are reserved for permit parking paid for by residents or illegally parking on yellow lines. Because of this, Sprowston Road traffic (including numerous buses) is being forced to mount the pavement, putting pedestrians at risk of being hit by vehicles, which I have seen myself, and experienced, on several occasions. This dangerous issue will only be exacerbated by the granting of this premises licence, creating further desires to park in the area from the venue's employees and patrons. It should also be noted that applicant's premise license notice (dated 19/04/2024) is no longer displayed at the premises as of 08/05/2024, despite requirement that the notice is displayed for 28 days since the date outlined on the notice. The applicant is, therefore, denying residents in the area knowledge of

	the application and ample opportunity to make representations should they wish.		
Please suggest any conditions which would alleviate your concerns	A full reconsideration of the use of the premises that does not necessitate any sort of license for alcohol/late night opening and refreshment. For example, retail only.		
:			
Full name:	Dr. Abby Kidd	Date:	2024-05-08

Fuller, Maxine

From: Abby Kidd <[REDACTED]>
Sent: 08 May 2024 12:03
To: LICENSING
Subject: Objection to Premises License Application - 2A Sprowston Road

External Email: Be cautious about the sender email address, attachments and links. If uncertain please delete the email.

Dear Norwich City Council Licensing Authority,

I'm writing to you in objection to the application from Colin Richard Shreeve for a Premises License for the sale of alcohol on the premises and the provision of late night refreshment at 2A Sprowston Road, NR3 4QN. The applicant wishes to use the premises as a pool/indoor sports bar between the hours of 10.30 and 23.00/24.00 daily.

Having thoroughly read the application on the Norwich City Council website, my objections are based on my concerns that the applicant has not fully understood and addressed the steps that they intend to take to promote the four licensing objectives, and therefore, they have not given diligent consideration to the extent of the negative impact this licensed premises could have on residents in the Sprowston Road area. The applicant has used just 48 words to outline how they will promote all four licensing objectives, which in my view is paltry and does not constitute a full acknowledgement of the steps that necessitate being taken to promote these objectives and protect the local area and community.

To further illustrate this, on page 4 of the application, the applicant has not identified recorded music as one of the licensable activities they intend to carry on from the premises. In contradiction, however, on page 16, the applicant states that recorded music will be played. Does the applicant intend to play music or not? How exactly does the applicant intend on ensuring that music will be 'low-level', especially late at night so as not to disturb residents?

In addition, on pages 15-6, the applicant has left the general steps they intend to take to promote the four licensing objectives entirely blank, again demonstrating a lack of rigorous consideration for the four licensing objectives as a whole. On page 16, the applicant states that excessive drinking and substance abuse 'won't be tolerated', but how exactly will these not be tolerated?

What are the steps that the applicant will take to ensure this prevention of crime and disorder? The mention of 'CCTV' is insufficient. In terms of public safety and nuisance, how does the applicant intend to ensure that there are 'no more than 30 members on site' at any given time? How does the applicant intend to encourage inebriated patrons not to 'loiter' outside the premises in order to prevent public nuisance? How exactly will the applicant ensure that under 16's on the premises are clearly identified so as not to run the risk of serving them alcohol, thus putting them at risk of harm? There is no consideration of procedure to protect residents, nor patrons and employees, throughout the entire application.

I am foremost concerned that the granting of this license will increase the possibility of public nuisance and crime and disorder for the many dwellings nearby, including my own. As aforementioned, I am especially apprehensive about noise nuisance, both from the music the applicant intends to play at the premises for over 12-hours a day 7-days a week and from patrons as they enter and exit the premises. For example, from what I can ascertain, patrons will be expected to loiter outside the front of the premises in the street to smoke/vape, which may not only result in an increase in litter in the form of cigarette butts and vape paraphernalia, but may also result in inebriated patrons taking alcohol served in glass vessels outside into the street that run the risk of being broken. This loitering could extend to neighbouring properties and may increase the risk of damage to said properties by inebriated patrons. Moreover, the sale of alcohol and on a late night basis encourages drinking culture, which in turn, could lead to an increase in violent crime in the immediate area. The thought of such disruptive incidents occurring so closely to my dwelling potentially on a daily basis is deeply concerning, and frankly, unacceptable.

Furthermore, there are already a number of premises licensed to sell alcohol in the locality, (The Stanley, Danomey's, The Brewery Tap, The Prince of Denmark, Urban Bull Lounge, The Artichoke, The Marlborough Arms, The Cottage, The Malt and Mardle, and The King's Head). Several of these venues already offer indoor sports such as pool, bar billiards, and darts. This is all without mention of Riley's Sports Bar, located on nearby Magdalen Street, which not only serves alcohol, but also has over 20 snooker/pool tables and a number of dart boards. Therefore, I would consider there to be more than sufficient licensed premises offering indoor sports within the area.

The granting of this premises license will also see an increase of visitor parking on Sprowston Road and the surrounding streets, which will not only pose a risk to public safety but also cause public nuisance. Parking on Sprowston Road has already worsened since the development of the larger building in which 2A Sprowston Road is situated, with employees and patrons of other new businesses frequently parking in spaces that are reserved for permit parking paid for by residents or illegally parking on yellow lines. Because of this, Sprowston Road traffic (including numerous buses) is being forced to mount the pavement, putting pedestrians at risk of being hit by vehicles, which I have seen myself, and experienced, on several occasions. This dangerous issue will only be exacerbated by the granting of this premises licence, creating further desires to park in the area from the venue's employees and patrons.

It should also be noted that applicant's premise license notice (dated 19/04/2024) is no longer displayed at the premises as of 08/05/2024, despite requirement that the notice is displayed for 28 days since the date outlined on the notice. The applicant is, therefore, denying residents in the area knowledge of the application and ample opportunity to make representations should they wish.

I sincerely appreciate your consideration of my objections and concerns to this premises license application.

Kind regards,
Dr. Abby Kidd



Fuller, Maxine

From: autoresponse@norwich.gov.uk
Sent: 09 May 2024 15:57
To: LICENSING
Subject: Online licensing representation form received

Norwich City Council

Licensing Authority

Licensing Act 2003

Statement of support or objection to an application for a premises licence

Your name/organisation name/name of body you represent	Roger Adams
Postal address	11 Sprowston Road, Norwich, NR3 4QL
Email address	
Contact telephone number	
What type of licencing are you supporting or objecting to?	Premises licence - alcohol and entertainment
Are you supporting an application or objecting to one?	Objecting to a licence
Address of the premises you wish to object to	2a Sprowston Road, Norwich

Your support or objection must relate to one of the four licensing objectives

Please give details of your support/objection in relation to at least one of the four licensing objectives	The address is next to a care home for vulnerable adults with learning difficulties. It is right opposite and below residential properties Parking would be an absolute nightmare The road is far too narrow to accomodate people outside smoking.
Please suggest any conditions which would alleaviate your concerns	I don't feel there are any.

:

Full name:	Roger Adams	Date:	2024-05-09
------------	-------------	-------	------------

Fuller, Maxine

From: autoresponse@norwich.gov.uk
Sent: 11 May 2024 15:44
To: LICENSING
Subject: Online licensing representation form received

Norwich City Council

Licensing Authority

Licensing Act 2003

Statement of support or objection to an application for a premises licence

Your name/organisation name/name of body you represent	Paul Youngs
Postal address	58 Clifton Street, Norwich, NR2 4NF
Email address	
Contact telephone number	
What type of licencing are you supporting or objecting to?	Premises licence - alcohol and entertainment
Are you supporting an application or objecting to one?	Objecting to a licence
Address of the premises you wish to object to	2A Sprowston Road , Norwich

Your support or objection must relate to one of the four licensing objectives

Please give details of your support/objection in relation to at least one of the four licensing objectives	I object to stopping the license to stop further crime , public disorder, prevent public nuisance, anti social behaviour , vandalism , theft to local residents.
Please suggest any conditions which would alleaviate your concerns	Not to go ahead . Happy for a local shop

:

Full name:	Paul Robin Youngs	Date:	2024-05-11
------------	-------------------	-------	------------

Fuller, Maxine

From: autoresponse@norwich.gov.uk
Sent: 12 May 2024 01:40
To: LICENSING
Subject: Online licensing representation form received

Norwich City Council

Licensing Authority

Licensing Act 2003

Statement of support or objection to an application for a premises licence

Your name/organisation name/name of body you represent	Damyon Mitchell-Hardy
Postal address	3 Northcote Road, Norwich, NR3 4QF
Email address	
Contact telephone number	
What type of licencing are you supporting or objecting to?	Premises licence - alcohol and entertainment
Are you supporting an application or objecting to one?	Objecting to a licence
Address of the premises you wish to object to	Sprowston Rd 'Joys'

Your support or objection must relate to one of the four licensing objectives

Please give details of your support/objection in relation to at least one of the four licensing objectives	This is not a suitable location for a pool and darts club selling alcohol for the following reasons. This is a residential area (including flats recently sold above the property) There are already parking issues, with cars being parked on the pavement in front of the premises and difficulty finding parking places for those holding resident permits. There have been issues with the supply of class A drugs in the vicinity and this could provide a hub for such activity. Concern about noise and disorder at closing times.
--	---

Please suggest any conditions which would alleaviate your concerns	Closing before 9pm
--	--------------------

:

Full name:	Damyon Mitchell-Hardy	Date:	2024-05-12
------------	-----------------------	-------	------------

Fuller, Maxine

From: autoresponse@norwich.gov.uk
Sent: 11 May 2024 22:07
To: LICENSING
Subject: Online licensing representation form received

Norwich City Council

Licensing Authority

Licensing Act 2003

Statement of support or objection to an application for a premises licence

Your name/organisation name/name of body you represent	Natalie Fox
Postal address	Anastasia House 2g, Sprowston Road, Norwich, NR3 4QN
Email address	
Contact telephone number	
What type of licencing are you supporting or objecting to?	Premises licence - alcohol and entertainment
Are you supporting an application or objecting to one?	Objecting to a licence
Address of the premises you wish to object to	Joys, 2a Sprowston Road, Norwich, NR3 4QN

Your support or objection must relate to one of the four licensing objectives

Please give details of your support/objection in relation to at least one of the four licensing objectives	<p>I am a resident living above the proposed establishment, I believe that the premises will cause a noise nuisance in the area and will affect myself and the other people living in the property. It is likely that there will also be a disturbance caused by customers outside the premises who are likely to stand outside to smoke and vape, this is more concerning if they are to be inebriated. Inebriated customers in a residential area are likely to cause a disturbance to residents. There is further concern with the property being located next to a care home. Late night sale of alcohol is expected to create an increase of anti-social behaviour, such as vandalism, littering, and possibly violence. It is worth noting that the Tesco a few minutes away has security guards on their premises at the weekend, suggesting that there is anti-social behaviour linked to the area.</p>
--	---

Please suggest any conditions which would alleviate your concerns

I do not believe that it is suitable to have a premises selling alcohol or playing music at night at this location.

:

Full name:

Natalie Louise Fox

Date:

2024-05-11

From: autoresponse@norwich.gov.uk
Sent: 29 May 2024 00:34
To: LICENSING
Subject: Online licensing representation form received

Norwich City Council

Licensing Authority

Licensing Act 2003

Statement of support or objection to an application for a premises licence

Your name/organisation name/name of body you represent	Nathaniel Crothers
Postal address	10 Sprowston Road, Norwich, NR3 4QN
Email address	
Contact telephone number	
What type of licencing are you supporting or objecting to?	Premises licence - alcohol and entertainment
Are you supporting an application or objecting to one?	Objecting to a licence
Address of the premises you wish to object to	2A Sprowston Road, NR3 4QN

Your support or objection must relate to one of the four licensing objectives

Please give details of your support/objection in relation to at least one of the four licensing objectives	<p>Dear Norwich City Council Licensing Authority, I am writing to formally object to Colin Shreeve's application for a Premises License at 2A Sprowston Road, NR3 4QN, intended for a pool/indoor sports bar with daily operations from 10:30 to 23:00/24:00, including the sale of alcohol and late-night refreshments. Upon reviewing the application on the Norwich City Council website, I have identified several critical concerns. The applicant's brief 48-word description of measures to promote the four licensing objectives is inadequate and lacks the necessary detail to address potential impacts on the surrounding community. Firstly, the application omits essential details regarding the promotion of licensing objectives on pages 15-16, which are left blank. This lack of information demonstrates a failure to comprehensively plan for public safety, crime prevention, and public nuisance</p>
--	--

mitigation. The claim that excessive drinking and substance abuse "won't be tolerated" is vague and unsupported by specific strategies, rendering the mention of CCTV insufficient without detailed implementation plans. Moreover, there are inconsistencies within the application regarding the use of recorded music. While page 4 does not list recorded music as a licensable activity, page 16 indicates its presence. This discrepancy raises concerns about the applicant's understanding and management of noise levels, particularly late at night, to avoid disturbing local residents. The application also fails to provide clear measures for managing patron numbers and preventing loitering, which could lead to public nuisance. The lack of a strategy for identifying underage individuals to prevent alcohol service is another significant oversight. I am particularly concerned about the potential increase in public nuisance and crime that could arise from granting this license. Noise disturbances from music and patrons, littering from smoking/vaping outside, and the risk of property damage from loitering are serious issues. The encouragement of a late-night drinking culture may further exacerbate violent crime in the area, which is a deeply troubling prospect for local residents, including myself. Additionally, the area is already adequately served by numerous licensed premises offering similar activities, such as The Stanley, Danomey's, The Brewery Tap, The Prince of Denmark, Urban Bull Lounge, The Artichoke, The Marlborough Arms, The Cottage, The Malt and Mardle, The King's Head, and Riley's Sports Bar on Magdalen Street. Given this context, the need for another licensed venue is questionable. Parking issues on Sprowston Road and adjacent streets are also a significant concern. The development at 2A Sprowston Road has already exacerbated parking problems, with illegal parking and encroachment on permit spaces. This situation forces traffic, including buses, to mount the pavement, endangering pedestrians. The addition of another venue will likely worsen these conditions. In light of these concerns, I urge the Licensing Authority to carefully consider the potential negative impacts on the community and deny this application. Thank you for considering my objections. Sincerely, Nathaniel Crothers

Please suggest any conditions which would alleviate your concerns

:

Full name:	Nathaniel Crothers	Date:	2024-05-29
------------	--------------------	-------	------------

Fuller, Maxine

From: autoresponse@norwich.gov.uk
Sent: 14 May 2024 13:44
To: LICENSING
Subject: Online licensing representation form received

Norwich City Council

Licensing Authority

Licensing Act 2003

Statement of support or objection to an application for a premises licence

Your name/organisation name/name of body you represent	Nigel Shaw
Postal address	1 Northcote Road, Norwich, NR3 4QF
Email address	
Contact telephone number	
What type of licencing are you supporting or objecting to?	Premises licence - alcohol and entertainment
Are you supporting an application or objecting to one?	Objecting to a licence
Address of the premises you wish to object to	2A Sprowston Road Norwich NR3 4QN

Your support or objection must relate to one of the four licensing objectives

Please give details of your support/objection in relation to at least one of the four licensing objectives	Public Nuisance - I am very concerned that the granting of this licence will have a very adverse effect on the quality of life of local residents, of which I am one. The application proposes to be open to the public seven days a week, 10.30 am to 11.00 pm (midnight on Fridays and Saturdays) and to serve alcohol from 11am to closing on each day. This is a residential district and I am concerned that the proposed hours will lead to an unacceptable increase in the levels of noise disturbance caused by the coming and going of customers, and by customers standing outside to smoke or vape. This will be exacerbated by the playing of music at the venue. As the application seeks for the service of alcohol up to the end of its opening hours I believe it likely that this will be an issue into the early hours of the morning. The venue is on main Sprowston Road with only the pavement outside. The overspill of customers onto this will not
--	--

	<p>only cause a nuisance for local residents but will also present an obstruction to pedestrians. Additionally the service of alcohol throughout the day until late evening may well see an increase in anti-social behaviour in this neighbourhood and the overspill of customers, some of whom could be inebriated ,onto the pavement outside could be felt to be threatening to residents and passers-by alike. Finally, parking has always been an issue for residents. The closure of the Collins Care store and its conversion into commercial and residential units (Anastasia House) has increased this problem. Parking by this venue's employees and customers will only exacerbate this further.</p>		
<p>Please suggest any conditions which would alleviate your concerns</p>	<p>No conditions would alleviate my concerns.</p>		
<p>:</p>			
<p>Full name:</p>	<p>Nigel Shaw</p>	<p>Date:</p>	<p>2024-05-14</p>

Fuller, Maxine

From: autoreponse@norwich.gov.uk
Sent: 14 May 2024 10:00
To: LICENSING
Subject: Online licensing representation form received

Norwich City Council

Licensing Authority

Licensing Act 2003

Statement of support or objection to an application for a premises licence

Your name/organisation name/name of body you represent	Lee Cawkwell
Postal address	5 Sprowston Road, Norwich, NR3 4QL
Email address	
Contact telephone number	
What type of licencing are you supporting or objecting to?	Premises licence - alcohol and entertainment
Are you supporting an application or objecting to one?	Objecting to a licence
Address of the premises you wish to object to	2A Sprowston Road

Your support or objection must relate to one of the four licensing objectives

Please give details of your support/objection in relation to at least one of the four licensing objectives	There is no requirement for this proposed establishment here. There are 3 pubs within 200 meters and a dedicated licensed pool and snooker club a short distance away. There's no parking and having inebriated loud customers leaving the place, will become a public nuisance in my opinion.
Please suggest any conditions which would alleviate your concerns	As a snooker and pool club it could work, but does not need to be a licensed premises.

:			
Full name:	Lee cawkwell	Date:	2024-05-14

LICENSING

From: autoresponse@norwich.gov.uk
Sent: 29 May 2024 21:16
To: LICENSING
Subject: Online licensing representation form received

Norwich City Council

Licensing Authority

Licensing Act 2003

Statement of support or objection to an application for a premises licence

Your name/organisation name/name of body you represent	Sarah Mitchell -hardy
Postal address	3 Northcote Road, Norwich, NR3 4QF
Email address	
Contact telephone number	
What type of licencing are you supporting or objecting to?	Premises licence - alcohol and entertainment
Are you supporting an application or objecting to one?	Objecting to a licence
Address of the premises you wish to object to	2 Sprowston road

Your support or objection must relate to one of the four licensing objectives

Please give details of your support/objection in relation to at least one of the four licensing objectives	Prevent public nuisance, crime prevention and public safety, caused by noise in a residential area and intoxication. Recent history if class a drug use in the area. Public safety No parking so users will park on pavements preventing use of push chairs
Please suggest any conditions which would alleaviate your concerns	None

:

Full name:	Sarah Mitchell-hardy	Date:	2024-05-29
------------	----------------------	-------	------------

LICENSING

From: autoresponse@norwich.gov.uk
Sent: 27 May 2024 16:04
To: LICENSING
Subject: Online licensing representation form received

Norwich City Council

Licensing Authority

Licensing Act 2003

Statement of support or objection to an application for a premises licence

Your name/organisation name/name of body you represent	Siobhan Pearson
Postal address	9 Sprowston Road, Norwich, NR3 4QL
Email address	
Contact telephone number	
What type of licencing are you supporting or objecting to?	Premises licence - alcohol and entertainment
Are you supporting an application or objecting to one?	Objecting to a licence
Address of the premises you wish to object to	2A Sprowston Road, Norwich

Your support or objection must relate to one of the four licensing objectives

Please give details of your support/objection in relation to at least one of the four licensing objectives	<p>My objections are related to three of the four licensing objectives. To prevent crime and disorder: naturally with any late night alcohol consumption, there is a high risk of an inebriated customer resorting to crime in a residential area. Such as destruction of public property, public urination and harassment. The Council has tried very hard to improve the residential areas surrounding Anglia Square and eradicating the excessive alcohol and drug use over the last few years, improving the overall living conditions. There is a huge concern that a sports bar is welcoming such behaviour back into the community. Public safety: there are no parking facilities nearby which means people who drive to this bar will be parking outside our homes or on the pathways. With limited road space as it is, this will inevitably cause traffic jams and potential car accidents. In connection to my point above regarding crime and disorder, drunk and</p>
--	--

	<p>disorderly customers are always a risk to the public safety due to unexpected and typically unsociable behaviours. To prevent public nuisance: my other concern is noise levels. Not just for me and my neighbours but for the residents of Point House. This establishment is an assisted living care facility for adults with learning or cognitive disabilities. I cannot imagine how disruptive it will be for them hearing music until the early hours of the morning, and drunk customers loitering outside their windows.</p> <p>Even if the music was kept at a relatively low volume for the rest of the neighbourhood, as Point House directly adjoins 2a Sprowston Road, this will be a constant disruption to Point House residence.</p>		
<p>Please suggest any conditions which would alleviate your concerns</p>	<p>It would be more suited to the community to open a cafe in this space, rather than a bar. Something family friendly and less disruptive.</p>		
<p>:</p>			
<p>Full name:</p>	<p>Siobhan Pearson</p>	<p>Date:</p>	<p>2024-05-27</p>

From: autoresponse@norwich.gov.uk
Sent: 08 May 2024 20:50
To: LICENSING
Subject: Online licensing representation form received

Norwich City Council

Licensing Authority

Licensing Act 2003

Statement of support or objection to an application for a premises licence

Your name/organisation name/name of body you represent	Ross Ferguson
Postal address	22 Sprowston Road, Norwich, NR3 4QN
Email address	
Contact telephone number	
What type of licencing are you supporting or objecting to?	Premises licence - alcohol and entertainment
Are you supporting an application or objecting to one?	Objecting to a licence
Address of the premises you wish to object to	2a Sprowston Road, NR3 4QN

Your support or objection must relate to one of the four licensing objectives

Please give details of your support/objection in relation to at least one of the four licensing objectives	<p>PUBLIC NUISANCE - It is not appropriate to have a licensed bar in the middle of a residential area, directly next to a care home. This would negatively affect the daily life's of the local community considering its going to be open 7 days week, til late, smokers outside, and drunk people loitering. There's no parking which is already a problem on the section of the street either. The state of those commercial units are very sub-standard and I doubt it will be a high-end finish. It will be a cheap pop up that damages the perception of what has been an upcoming area(NR3). As a mortgage broker, I can confirm that a commercial property like that in a highly populated residential area is highly undesirable for new buyers and new investment, and can render surrounding residentials unmortgageable.</p>
--	--

Please suggest any conditions which would alleviate your concerns	Rejecting the claim would alleviate concerns. There is no compromised version of this being acceptable for local residents.		
:			
Full name:	Ross Ferguson	Date:	2024-05-08

From: autoresponse@norwich.gov.uk
Sent: 09 May 2024 15:29
To: LICENSING
Subject: Online licensing representation form received

Norwich City Council

Licensing Authority

Licensing Act 2003

Statement of support or objection to an application for a premises licence

Your name/organisation name/name of body you represent	Hannah Cutts
Postal address	11 Sprowston Road, Norwich, NR3 4QL
Email address	[REDACTED]
Contact telephone number	[REDACTED]
What type of licencing are you supporting or objecting to?	Premises licence - alcohol and entertainment
Are you supporting an application or objecting to one?	Objecting to a licence
Address of the premises you wish to object to	2A Sprowston Road Norwich NR3 4QN

Your support or objection must relate to one of the four licensing objectives

Please give details of your support/objection in relation to at least one of the four licensing objectives	<p>The plan is for this (very small) premises to be a pool and darts bar, open 7 days a week between 10:30 and 23:00 (00:00 on Fridays and Saturdays). This is right in the middle of a very residential area and next door to a care home for people with additional needs. As it is such a small premises it is likely we will see an increase in noise disturbance and nuisance from inebriated customers of the bar. There is no garden area so customers will need to congregate outside the front of the location to smoke/vape, which could be seen as public disturbance and a threat to the safety of the vulnerable adults who live next door. It is to be expected, with any premises that sells alcohol, that there could be an increase in crime, vandalism, littering (especially with such limited space at the venue). Then there's the issue of parking - the premises has no parking on site, and on street parking in the area is already very stretched and</p>
--	---

	<p>limited, there just isn't the space for the traffic that this venue could bring to the area, leading to the possibility of illegal parking and the residents in the area struggling to park. We are very, very concerned about the possibility of this venue opening so please consider not allowing the licence to go through. Thank you</p>		
<p>Please suggest any conditions which would alleviate your concerns</p>	<p>I don't think there is anything that could alleviate the concerns for this particular plan, the premises is far too small and in the wrong place for what is planned.</p>		
<p>:</p>			
<p>Full name:</p>	<p>Hannah Cutts</p>	<p>Date:</p>	<p>2024-05-09</p>