

APPENDIX A



NORWICH
City Council

Schedule 12

Regulation 33,34

Premises Licence

Premises Licence Number

10/01640/PREMTR

Part 1 – Premises Details

Postal address of premises, or if none, ordnance survey map reference or description, including Post Town, Post Code

Hollywood Bowl
Wherry Road
Norwich
Norfolk
NR1 1WZ

Telephone number 01603 631311

Where the licence is time limited the dates

Not applicable

Licensable activities authorised by the licence.

Films - Activity takes place indoors
Indoor Sporting Events - Activity takes place indoors
Late Night Refreshment - Activity takes place indoors
Sale by Retail of Alcohol - Activity takes place indoors
Recorded Music - Activity takes place Indoors

Private Entertainment as defined under section 2 of the Private Places of Entertainment (Licensing) Act 1967

The times the licence authorises the carrying out of licensable activities

Films	Every Day	10:00 - 01:00
Indoor Sporting Events	Every Day	09:00 - 01:00
Late Night Refreshment	Every Day	23:00 - 01:00
Late Night Refreshment	New Years Eve to New Years Day	23:00 - 05:00
Sale by Retail of Alcohol	Every Day	10:00 - 01:00
Sale by Retail of Alcohol	New Years Eve to New Years Day	-
Recorded Music	Every Day	-

Non Standard/Seasonal Timings

In the event of the transmission of any recognised international event which falls outside the current permitted hours on the premises licence to permit all activities commencing one hour before the start of the event and end one hour after the start of the event. Details of which to be notified in writing to the Police 14 days beforehand. The event will not proceed if the Police serve, 7 days prior to the event, written notice upon the Designated Premises Supervisor.

On the days/dates listed below the additional hours are to be permitted for all licensable activities:

1 January 1hr, Valentines Night 1hr, Burns Night 1hr, 1 March (St David's) 1hr, 17 March (St Patrick's) 2hrs, Easter Sunday 1hr, Easter Monday 1hr, May Bank Holiday (1st) Sunday prior 2 hrs, May Bank Holiday (1st) Bank Holiday Monday 1hr, May Bank Holiday (2nd) Sunday prior 2hrs, May Bank Holiday (2nd) Bank Holiday Monday 1hr, Halloween 1hr, Christmas Eve 2hrs, Boxing Day 2hrs, 27 December 2hrs, 28 December 2hrs, 30 December 2hrs.

The opening hours of the premises

Monday	08:00 - 01:30
Tuesday	08:00 - 01:30
Wednesday	08:00 - 01:30
Thursday	08:00 - 01:30
Friday	08:00 - 01:30
Saturday	08:00 - 01:30
Sunday	08:00 - 01:30

Non Standard/Seasonal Timings

New Years Eve to New Years Day.

In the event of the transmission of any recognised international event which falls outside the current permitted hours on the premises licence to permit all activities commencing one hour before the start of the event and end one hour after the start of the event. Details of which to be notified in writing to the Police 14 days beforehand. The event will not proceed if the Police serve, 7 days prior to the event, written notice upon the Designated Premises Supervisor.

On the days/dates listed below the additional hours are to be permitted for all licensable activities:

1 January 1hr, Valentines Night 1hr, Burns Night 1hr, 1 March (St David's) 1hr, 17 March (St Patrick's) 2hrs, Easter Sunday 1hr, Easter Monday 1hr, May Bank Holiday (1st) Sunday prior 2 hrs, May Bank Holiday (1st) Bank Holiday Monday 1hr, May Bank Holiday (2nd) Sunday prior 2hrs, May Bank Holiday (2nd) Bank Holiday Monday 1hr, Halloween 1hr, Christmas Eve 2hrs, Boxing Day 2hrs, 27 December 2hrs, 28 December 2hrs, 30 December 2hrs.

Where the licence authorises supplies of alcohol whether these are on and / or off supplies

Alcohol is supplied for consumption both on and off the Premise

State whether access to the premises by children is restricted or prohibited

Part 2

Name, (registered) address, telephone number and email (where relevant) of holder of premises licence

The Original Bowling Company Limited
Focus 31
North Wing
Cleveland Road
Hemel Hempstead
HP2 7BW

Telephone Number 91442840200

Registered number of holder, for example company number, charity number (where applicable)

Registered Business Number 05163827

Name, address and telephone number of designated premises supervisor where the premises licence authorises for the supply of alcohol

Roderick John Trimble
40 Holyoake Road
Wollastow
Northants
NN29 7RZ

Personal licence number and issuing authority of personal licence held by designated premises supervisor where the premises licence authorises for the supply of alcohol

Party Reference: MAID0185/LP/0446

Licensing Authority: Maidstone Council

Annex 1 – Mandatory conditions

- 1 No supply of alcohol may be made under a premises licence -
 - (a) at a time when there is no designated premises supervisor in respect of the premises licence, or
 - (b) at a time when the designated premises supervisor does not hold a personal licence or his personal licence is suspended.
- 2 Every supply of alcohol under the premises licence must be made or authorised by a person who holds a personal licence.
- 3 No moving picture shall be exhibited unless: -
 - (i) it has received a "U", "PG", "12A", "15" or "18" certificate of the British Board of Film Classification; or
 - (ii) it is a current newsreel which has not been submitted to the British Board of Film Classification; or
 - (iii) the permission of the Licensing Authority is first obtained and any conditions of such permission are complied with.
- 4 No person under the age of 18 years shall be admitted to any exhibition at which there is to be shown any moving picture which has received an "18" certificate from the British Board of Film Classification.
- 5 No person under the age of 15 years shall be admitted to any exhibition at which there is to be shown any moving picture which has received a "15" certificate from the British Board of Film Classification.
- 6 No person under the age of 12 years shall be admitted to any exhibition at which there is to be shown any moving picture which has received a "12A" certificate from the British Board of Film Classification.
- 7 Where, at specified times one or more individuals must be at the premises to carry out a security activity each such individual must be licensed by the Security Industry Authority.
- 8 (1) The responsible person shall take all reasonable steps to ensure that staff on relevant premises do not carry out, arrange or participate in any irresponsible promotions in relation to the premises.

(2) In this paragraph, an irresponsible promotion means any one or more of the following activities, or substantially similar activities, carried on for the purpose of encouraging the sale or supply of alcohol for consumption on the premises in a manner which carries a significant risk of leading or contributing to crime and disorder, prejudice to public safety, public nuisance, or harm to children -

 - (a) games or other activities which require or encourage, or are designed to require or encourage, individuals to -
 - (i) drink a quantity of alcohol within a time limit (other than to drink alcohol sold or supplied on the premises before the cessation of the period in which the responsible person is authorised to sell or supply alcohol), or
 - (ii) drink as much alcohol as possible (whether within a time limit or otherwise);
 - (b) provision of unlimited or unspecified quantities of alcohol free or for a fixed or discounted fee to the public or to a group defined by a particular characteristic (other than any promotion or discount available to an individual in respect of alcohol for consumption at a table meal, as defined in section 159 of the Act);
 - (c) provision of free or discounted alcohol or any other thing as a prize to encourage or reward the purchase and consumption of alcohol over a period of 24 hours or less;
 - (d) provision of free or discounted alcohol in relation to the viewing on the premises of a sporting event, where that provision is dependent on -
 - (i) the outcome of a race, competition or other event or process, or
 - (ii) the likelihood of anything occurring or not occurring;

(e) *selling or supplying alcohol in association with promotional posters or flyers on, or in the vicinity of, the premises which can reasonably be considered to condone, encourage or glamorise anti-social behaviour or to refer to the effects of drunkenness in any favourable manner.*

9 The responsible person shall ensure that no alcohol is dispensed directly by one person into the mouth of another (other than where that other person is unable to drink without assistance by reason of a disability).

10 The responsible person shall ensure that free tap water is provided on request to customers where it is reasonably available.

11 (with effect from 1 October 2010)

(1) The premises licence holder or club premises certificate holder shall ensure that an age verification policy applies to the premises in relation to the sale or supply of alcohol.

(2) The policy must require individuals who appear to the responsible person to be under 18 years of age (or such older age as may be specified in the policy) to produce on request, before being served alcohol, identification bearing their photograph, date of birth and a holographic mark.

12 (with effect from 1 October 2010)

The responsible person shall ensure that -

(a) where any of the following alcoholic drinks is sold or supplied for consumption on the premises (other than alcoholic drinks sold or supplied having been made up in advance ready for sale or supply in a securely closed container) it is available to customers in the following measures -

(i) beer or cider: half pint;

(ii) gin, rum, vodka or whisky: 25 ml or 35 ml; and

(iii) still wine in a glass: 125 ml; and

(b) customers are made aware of the availability of these measures.

Annex 2 – Conditions consistent with the Operating Schedule

1 **General - all four licensing objectives**

2 Staff will be trained to company policies and in relevant legislation.

3 There will be a 30 minute wind down period following the end of the sale of alcohol.

4 **The Prevention of Crime and Disorder**

5 The premises will monitor the need for door supervisors and in doing so will take into account any advice from the Police.

6 The pub manager will actively participate in and support the local Pubwatch scheme.

7 Text and / or radio pagers where already used will be used for the additional hours.

8 Toughened glass will be in use in the premises.

9 CCTV will be in operation at the premises.

10 There will be no promotions that encourage illegal, irresponsible or immoderate consumption of alcohol in line with the company's Alcohol and Social Responsibility.

11 **Public Safety**

12 Health and Safety legislation will be complied with through policies and practices including due diligence and incident reporting systems.

13 **The Prevention of Public Nuisance**

14 Steps will be taken to recognise the rights of local residents and to encourage customers to leave the premises quietly.

15 Managers of the premises will liaise with local neighbours as part of their duties and will resolve any reasonable concerns in accordance with the company's Role in the Community Guidelines.

16 **The Protection of Children From Harm**

17 All staff are briefed in the importance of their responsibilities in ensuring customers are over 18.

18 No adult entertainment of a nude physical nature is permitted at these premises.

19 Any children under 16 remain the responsibility of the accompanying adult when using the premises.

20 Staff are not allowed to be in sole supervision of children which remains the responsibility of the accompanying adult at all times.

Annex 3 – Conditions attached after a hearing by the licensing authority

APPENDIX B

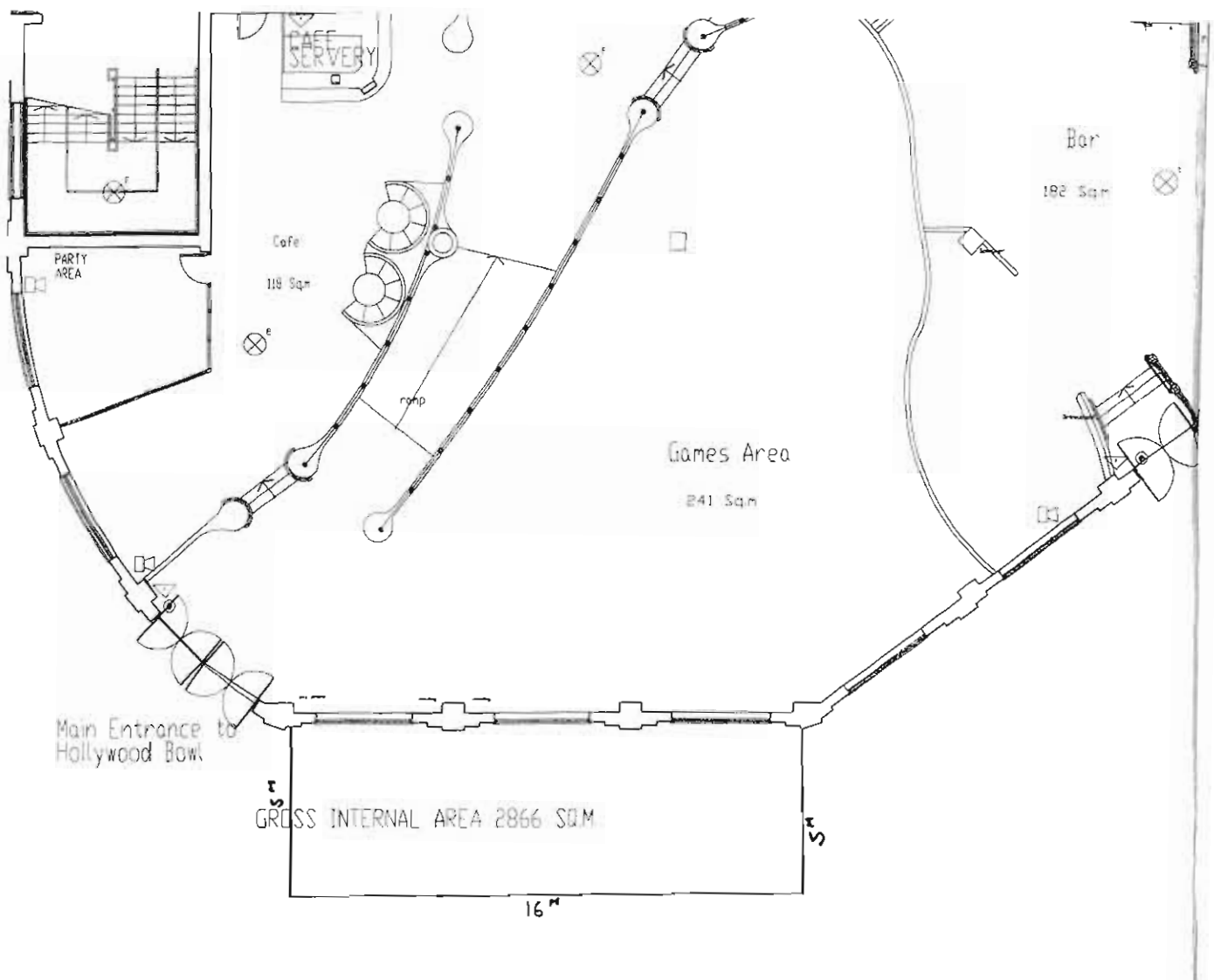

**Statement of support or objection to
an application for a premises licence**

Your name/organisation name/name of body you represent (see note 1)	Mary Wisbey ODEON / UCI CINEMA LTD
Postal address	Odeon LTD Riverside, Wherry Road, NR1 1XA
Email address	
Contact telephone number	

Name of the premises you wish to object to	Hollywood Bowl - Riverside
Address of the premises you wish to object to.	Hollywood Bowl, Wherry Road, Riverside, Norwich, NR1

Your support or objection must relate to one of the four Licensing Objectives (see note 2)

Licensing Objective	Please set out your <u>objections</u> below. Please use separate sheets if necessary
To prevent crime and disorder	<p>1) I believe that the following should be taken into account :</p> <p>-a) Surveillance –will become crowded and limited in the public space.</p> <p>-b) Image - The extension does not improve the areas image and could add stigma to a main area of Norwich next to the main railway station and is alongside a main tourist route.</p> <p>-c) Territoriality – The application goes against the capacity of the physical environment to create a feeling of neighbourhood and encourage residents to exercise surveillance over the area of defensible space.</p>
Public safety	<p>1) Under the Riverside / Public right of way the exit from the cinema must be the same width as the front doors all the way from the front exit doors of the ODEON to Wherry Road. Additional seating & tables would narrow this exit way thus breaking this ruling and endangering members of the public.</p> <p>2) The public will be at risk as they are funnelled, becoming narrower and narrower from the cinema main Exit / Fire doors. T</p> <p>3) The main Fire exit to screen one will be blocked by tables & chairs.</p> <p>4) Please contact George Bray from Norwich Fire services</p>
To prevent public nuisance	<p>1) Members of the public already stray out of the designated areas from Hollywood Bowl itself on to the concrete seats. Additional outside seating next to the Cinema would add an opportunity for people to additionally stray and pass alcohol and litter the area.</p>
To protect children from harm	<p>1) Unaccompanied children (teenagers), visit the cinema. The addition drinking area directly outside the cinema would give children access to alcohol by helping themselves to left over drinks.</p> <p>2) Children would have to past an enclosed space where members of the public were drinking alcohol.</p>

Please suggest any conditions which would alleviate your concerns.	
---	--

Signed: Mary Wisbey
Please see notes on reverse

Date: 4th August 2011.

Norwich City Council Licensing Authority
Licensing Act 2003

CORPORATE RESOURCES

08 AUG 2011

POST ROOM

Statement of support or objection to
an application for a premises licence

Your name/organisation name/name of body you represent (see note 1)	FRANCES PERLMAN
Postal address	44 SIDESTRAND
Email address	
Contact telephone number	
Name of the premises you wish to support or object to	HOLLYWOOD BOWL
Address of the premises you wish to support or object to.	WHERRY ROAD

Your support or objection must relate to one of the four Licensing Objectives (see note 2)

Licensing Objective	Please set out your support or objections below. Please use separate sheets if necessary
To prevent crime and disorder	<p>IT IS VITAL THAT WE PROTECT THE PEACE OF WHERRY ROAD. EXTENDED SALE OF ALCOHOL & RECORDED MUSIC IS LIKELY TO TURN THIS AREA INTO ANOTHER PRINCE OF WALES ROAD. WE NEED TO FEEL SAFE GOING OUT AT NIGHT & NOT HAVE TO GO PAST DRUNKS. ALSO, THE NOISE WILL BE A BIG DISTURBANCE. BOTH OF THESE FACTORS WILL REDUCE THE SALE PRICE OF OUR HOMES.</p> <p>THERE ARE CHILDREN OUT ON THE STREET LATE AT NIGHT, AND THEY MUST BE PROTECTED.</p>
Public safety	
To prevent public nuisance	
To protect children from harm	

Please suggest any conditions which would alleviate your concerns.	THERE ARE NONE. THE SAFETY & PEACE OF OUR RESIDENTS COMES BEFORE HOLLYWOOD BOWL.
--	--

Signec

Please see notes on reverse

August 4th 2011

RECEIVED
08 AUG 2011
LICENSING OFFICE

Norwich City Council Licensing Authority
Licensing Act 2003

REF: 50

- 9 Aug 2011

Statement of support or objection to
an application for a premises licence

Your name/organisation name/name of body you represent (see note 1)	Hazel Smith
Postal address	39 Wherry Road Norwich NR1 1LS
Email address	
Contact telephone number	
Name of the premises you wish to support or object to	HOLLYWOOD BOWL
Address of the premises you wish to support or object to.	Wherry Road NORWICH NR1 1LS

Your support or objection must relate to one of the four Licensing Objectives (see note 2)

Licensing Objective	Please set out your support or objections below. Please use separate sheets if necessary
To prevent crime and disorder	
Public safety	
To prevent public nuisance	
To protect children from harm	

Please suggest any conditions which would alleviate your concerns.	<ul style="list-style-type: none"> more community Policing during open hours and immediately after closing Better cleaning of surrounding areas.
--	--

Signed:

Date:

Please see notes on reverse

7-8-2011

Statement of Objection to application by Hollywood Bowl Wherry Road Norwich NR1 1WZ

The area is already well served by licensed premises, indeed one of these the previous Norwegian Blue is not in operation.

Hollywood bowl is a premises to support an activity used by all ages including children, this fits well with the cinema, local shopping and vicinity to the city centre and rail station, a family or group of mixed ages can enjoy a varied day out. Those who wish to listen to music and drink alcohol have many choices of venue very close by.

Any drinking of alcohol in public premises later in the evening and particularly into the early morning brings issues with it

- Crime and disorder

Supervision by policing or others is reduced at these times

Fewer people are in the streets allowing for unsocial behaviour to occur unseen, particularly noise, vandalism, behaviour likely to intimidate others.

- Public nuisance

Taxis are using Wherry Road to drop off passengers using premises beyond the bollards.

The trees are continually being damaged.

Noise is becoming more common after opening hours in the residential part of Wherry road.

Any increase in licensing hours will only make this more likely and worse.

- Public safety

Broken glass is a very real problem in the area around the current licensed premises, over the bridge and by the river.

Outside drinking makes this more likely as there is less control of the behaviour of the customers

The area is lived in by people of all ages, the flats are popular for older people as well as younger and there are children living here and visiting family here too

At present the situation in this area has deteriorated from what it was months and certainly a year ago. I am supposing that this is due to less traffic warden and community police presence.

I like to see people enjoying themselves, dancing and music are not undesirable but this is a good area for family entertainment with the Riverside swimming pool complex, Football ground and Cinema and the Bowling is part of this but it is important to maintain a balance and if the Hollywood bowl extends to late night drinking and disco the balance of the area as a place for all ages will be reduced.

I therefore object strongly to the changes

Hazel Smith
39 Wherry Road
Norwich
NR1 1WS
[REDACTED]