

## Report for Resolution

<b>Report to</b>	Norwich Highways Agency Committee 26 March 2009
<b>Report of</b>	Head of Transportation and Landscape
<b>Subject</b>	Magdalen Road/St Clements Hill Pedestrian Facilities Scheme

---

**Item**  
**7**

### Purpose

This report informs Members of the results of public consultation on proposals to address local peoples concerns about safety and the lack of pedestrian crossing facilities on Magdalen Road from its junction with Waterloo Road to Constitution Hill.

### Recommendations

The Committee is recommended to:-

- (1) approve the proposals as shown on Drawings 08/HD/057/01 (Appendix 1), except for the provision of the mini roundabout at the junction of Waterloo Road.
- (2) ask the Head of Transportation and Landscape and Landscape and Head of Legal and Democratic Services to progress the necessary statutory procedures associated with extending the 20mph speed limit from Constitution Hill along Magdalen Road to its junction with Waterloo Road, as shown on plan 08/HD/057/05.

### Financial Consequences

The Local Transport Plan has allocated £150,000 budget to fund this scheme.

### Strategic Priority and Outcome/Service Priorities

The report helps to meet the strategic priority “Strong and prosperous city – working to improve quality of life for residents, visitors and those who work in the city now and in the future” and the service plan priority of delivering the Local Transport Plan.

### Contact Officers

Joanne Deverick, Transportation Manager	01603 213430
Tony Cozens, Principal Technical Officer	01603 213469

### Background Documents

None.

## **Background**

1. For many years concerns have been expressed about safety at the Magdalen Road / St Clements Hill / Constitution Hill junction by local members. However while there is a consistent history of collisions at the site, they have never reached the levels where a local safety scheme could be justified. These concerns were heightened in February 2007 when a young woman was killed by a speeding motorist late at night, although the coroner subsequently ruled that the road layout was not a contributory factor.
2. In addition to the accident concerns there are 3 outstanding requests for pedestrian crossings in the area, on Constitution Hill, north of Denmark Road, Magdalen Road, south of Denmark Road and Waterloo Road by Magdalen Road.
3. In the traffic calming priority list Magdalen Road is one of the top priorities.
4. These 3 factors prompted a bid for funding for improvements from the LTP budget, with money in 2008/09 to develop the scheme and funds in 2009/10 to implement it.

## **The Proposals.**

5. Taking into consideration all the issues above the following scheme was suggested.
  - Amend the junction layout to reduce vehicle speeds entering St Clements Hill and conflicts with pedestrians.
  - Amend the junction layout to reduce vehicle speeds entering and exiting Denmark Road.
  - Provide a mini roundabout at the junction of Waterloo Road to reduce vehicle speeds.
  - Provide a new crossing outside 144 Magdalen Road, either a zebra crossing or a pedestrian refuge.

The Appendices 2 and 3 show the proposed scheme with the alternative crossing options.

## **Results of Consultation**

6. In January 2009 consultation was carried out with key stakeholders and residents offering two possible solutions.
7. The response to the consultation was 39 preferring the Zebra crossing and 10 preferring the pedestrian refuge. Comments from respondents are summarised in Appendix 3

## **Ward Member Comments**

8. The 3 district ward members and the county member all preferred the zebra crossing option, but were disappointed that a dedicated crossing was not provided on Waterloo Road at it's junction with Magdalen Road.
9. Waterloo Road is too narrow to accommodate a pedestrian refuge and a zebra (or signalled) crossing would need to be sited too far from the junction mouth to make it useful to the vast majority of pedestrians.

## **Conclusion**

10. The consultation revealed a clear preference for the zebra crossing option, shown on appendix one.
11. In light of the ward member concerns it has been decided to replace the mini-roundabout at the Magdalen Road Waterloo Road junction with a speed table, covering all arms of the junction. This will reduce speeds to a level that will mean pedestrians find it easier to cross.
12. As part of the consultation some respondents asked for the 20mph speed limit on Constitution Hill to be extended. Speed surveys indicate the existing 85<sup>th</sup> percentile speed as 25mph and with the new measures a 20mph speed limit would be justified
13. The extent of the 20mph limit and the suggested new speed table is shown on Plan 08 HD 057 05 (Appendix 4).

## Appendix 1 – Option 1 with Zebra Crossing

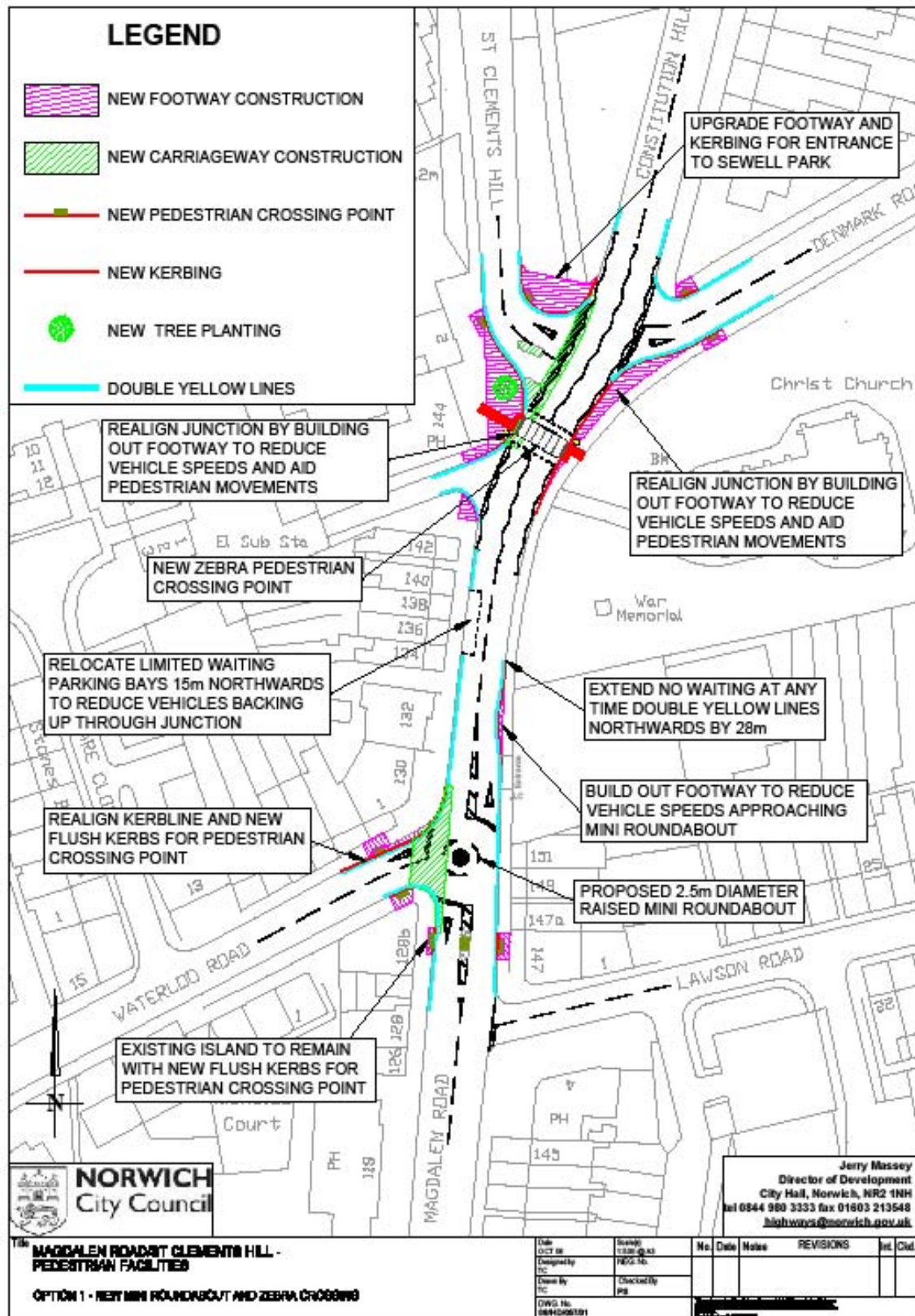

## Appendix 2 – Option 2 with Pedestrian Island

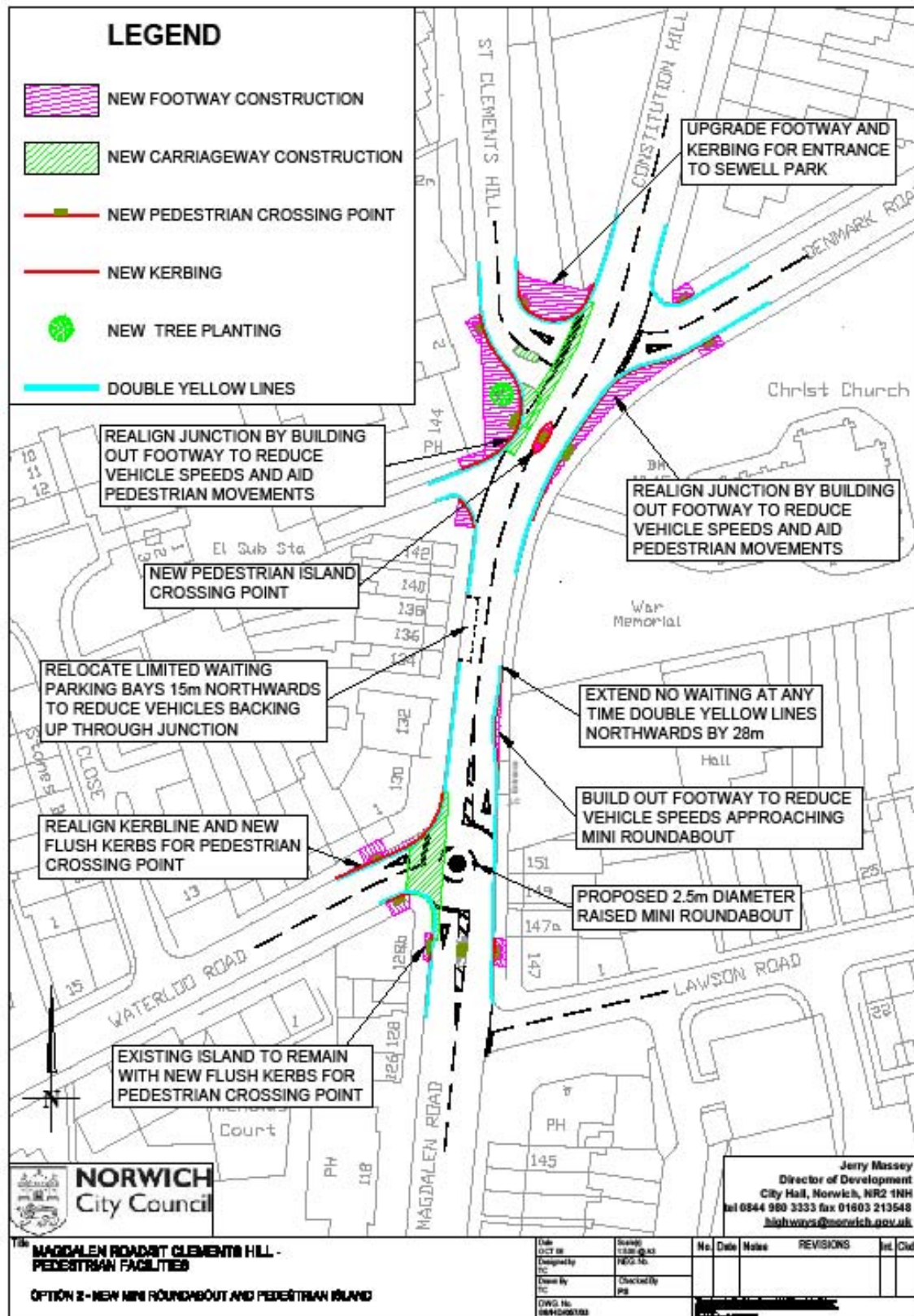

## Appendix 3 – Summary of Consultation

Consultation Results for Magdalen Road									
NAME	HOUSE No	STREET NAME	OPTION 1	OPTION 2	COMMENTS				
Resident	29	Capps Road	1						
Resident	4	Chamberlin Close	1						Other
Vicar	8	Christ Church	1		1				Stopping outside church gate
Resident	16	Constitution Hill	1						1
Resident	18	Constitution Hill	1						
Resident	?	Constitution Hill	1						1
Resident	18a	Constitution Hill		1					
Resident	20a	Constitution Hill	1						Island Denmark Rd - crossing Constitution Hill - raise kerbs on Lawson Rd
Resident	10	Constitution Hill		1					
Resident	8	Denmark Road		1					
Resident	12	Denmark Road	1						
Resident	14	Denmark Road	1			1			
Resident	16	Denmark Road	1						Traffic calming for Denmark Road
Resident	18	Denmark Road	1						Can the zebra be moved to outside park
Resident	22	Denmark Road	1						Concerned about how close zebra is to exit of Denmark Road
Resident	10	Denmark Road	1						
Ann Bond		Heat	1						Detail
Owner	132	Magdalen Road		1	1			1	Worried at loss of parking - no mini roundabout
Resident	134	Magdalen Road	1						Do not remove yellow lines o/s 134-140
Resident	136	Magdalen Road	1						Likes both options - likes tree
Resident	140	Magdalen Road		1					Good idea
Resident	141	Magdalen Road	1						
Resident	144	Magdalen Road	1						How do deliveries get to pub?
Resident	151	Magdalen Road		1					Good idea
Resident	147a	Magdalen Road	1						
Resident	3	Nicholas Court		1					
Resident	64	Pelham Road	1						
Resident	140	Rosebery Road	1						
Business Director		Sewell Park College	1		1				Improve visibility at St Clements Hill - mini roundabouts
Resident	20	St Clements Hill	1			1			Mini Roundabout St Clements - One-way St Clements Hill
Resident	24	St Clements Hill	1						
Resident	26	St Clements Hill	1						
Resident	34	St Clements Hill	1						
Resident	56	St Olaves Road	1						
Resident	7	Waterloo Road	1						
Owner	1	Waterloo Road	1	1					Move crossing point further down Waterloo Rd
First Bus				1					Minimal disruption to service
Norwich Access Group			1						
Resident				1					
Living Streets			1						
Clr Sands			1			1			
Clr Brociek-Coulton			1			1			
Norwich Cycling Campaign			1						no build out opposite 132
Clr Barham			1		1				1 Resurface footway by Christchurch community centre
Norfolk Constabulary			1						Concerned regarding right turn from Waterloo Road
Clr Ward			1		1	1			
Norfolk Fire Service			1						
		TOTALS	39	10	6	5	1	3	



## Appendix 4 – Proposed 20mph Speed Limit

