

Appendix 5 - Revised premises licence plan

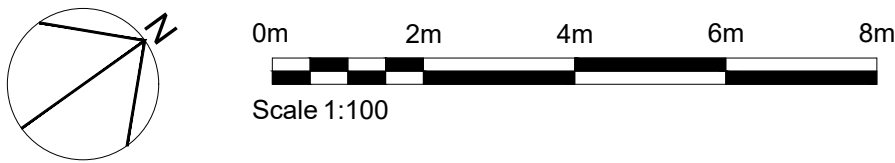

All dimensions to be verified on site by Main Contractor before the start of any shop drawings or work whatsoever either on their own behalf or that of sub-contractors. Report any discrepancies to the Contract Administrator at once. This drawing is to be read with all relevant Architect's and Engineer's drawings and other relevant information.

© Richard Pike Associates Do Not Scale

Notes:

DRAWING KEY

- Internal Premises licence boundary
- Outside area

FIRE PROTECTION

- EF-bg BREAKGLASS CALL POINT
- EF-bg-k KEY OPERATED MANUAL CALL POINT
- EF-bg-sv BREAK GLASS CALL POINT FOR SMOKE VENT
- EF-fcp FIRE TELEPHONE CALL POINT
- EF-sd SMOKE DETECTOR - 'I' DENOTES IONISATION, 'O' DENOTES OPTICAL
- EF-sd-s SMOKE DETECTOR WITH SOUNDER BASE
- EF-sd-v SMOKE DETECTOR WITHIN VOID
- EF-sd-sv SMOKE DETECTOR FOR SMOKE VENT
- EF-sd-sb SMOKE DETECTOR WITH BEACON & SOUNDER
- EF-sd-d DUCT SMOKE DETECTOR
- EF-sd-sc SMOKE DETECTOR FOR SMOKE CLEARANCE SYSTEM
- EF-hd HEAT DETECTOR FIXED TEMPERATURE - 'R' INDICATES RATE OF RISE, 'IR' DENOTES INFRA-RED
- EF-hd-s HEAT DETECTOR WITH SOUNDER BASE
- EF-hd-sb HEAT DETECTOR WITH SOUNDER BASE & BEACON
- EF-shd COMBINED SMOKE AND HEAT DETECTOR
- EF-bsd-t BEAM SMOKE DETECTOR (TRANSMITTER)
- EF-bsd-r BEAM SMOKE DETECTOR (RECEIVER)
- EF-fd FLAME DETECTOR
- EF-mdh MAGNETIC DOOR HOLD (FIRE ALARM OPERATED)
- EF-fab FIRE ALARM BELL
- EF-sp-c CEILING / WALL MOUNTED SPEAKER
- EF-sp-w
- EF-sp-b BI-DIRECTIONAL SPEAKER
- EF-fas FIRE ALARM ELECTRONIC SOUNDER
- EF-im INTERFACE MODULE - 1 or 2 CONTACTS TYPE 1 - DENOTES INPUT & TYPE O DENOTES OUTPUT
- EF-ri REMOTE INDICATOR
- EF-xfb-c LED/XENON FLASHING BEACON (CEILING MOUNTED)
- EF-xfb-w LED/XENON FLASHING BEACON (WALL MOUNTED)
- EF-xfbs-c LED/XENON FLASHING BEACON WITH SOUNDER (CEILING MOUNTED)
- EF-xfbs-w LED/XENON FLASHING BEACON WITH SOUNDER (WALL MOUNTED)
- EF-fap FIRE ALARM PANEL
- EF-farp FIRE ALARM REPEATER PANEL
- EF-famp FIRE ALARM MIMIC PANEL
- EF-ss SYSTEM STATUS INDICATOR PANEL
- EF-sci SHORT CIRCUIT INDICATOR
- EF-pa PUBLIC ADDRESS SYSTEM
- 2KG C02 PORTABLE EXTINGUISHER
- 6L AFF PORTABLE EXTINGUISHER
- FIRE BLANKET

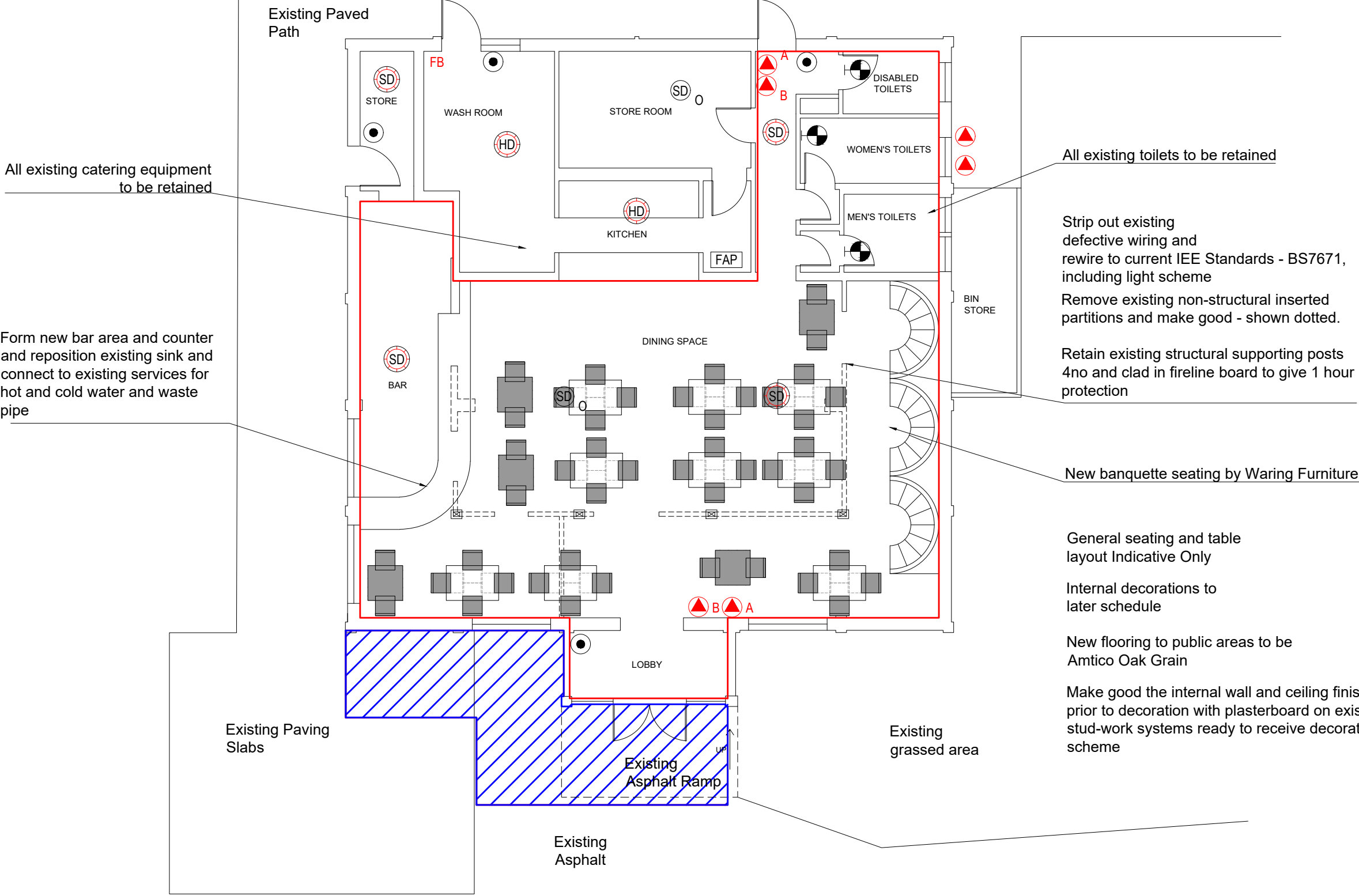

P4	11.09.19	North arrow amended	AF	RP
P3	11.09.19	Amended external premises licence area	AF	RP
P2	31.07.19	Outside area changed to blue hatching	AF	RP
P1	04.07.19	First Issue	AF	RP
Rev:	Date:	Description:	Chk:	Apr:



Richard Pike Associates
Building, Design & Planning Specialists

Jonathan Scott Hall
Thorpe Road
Norwich
Norfolk
NR1 1UH
t: 01603 611323
e: info@richardpike.co.uk
www.richardpike.co.uk



Certificate No. GB200372 Registration No. 004471

Project:
Pedro's Restaurant Ltd
Chapelfield Gardens
Norwich, NR2 1NY

Drawing Title:
Floor Plan - Premises Licence

Client:
Surrus Property Company Ltd

Scale: 1:100 @A2 Date: 04.07.19

Project Number: Drawing Number: Revision:

18058 - 1201	P4
Information	