

Licensing sub committee

Date: Tuesday, 28 October 2014

Time: 14:00

Venue: Wymer room

City Hall, St Peters Street, Norwich, NR2 1NH

Pre-meeting briefing – 14:00

Committee members:

For further information please contact:

COMMITTEE MEMBERS:

Councillors:

Button (Chair)

Ackroyd

Jones

Committee officer: Lucy Green

t: (01603) 212416

e: lucygreen@norwich.gov.uk

Democratic services

City Hall

Norwich

NR2 1NH

www.norwich.gov.uk

Information for members of the public

Members of the public and the media have the right to attend meetings of full council, the cabinet and committees except where confidential information or exempt information is likely to be disclosed, and the meeting is therefore held in private.

For information about attending or speaking at meetings, please contact the committee officer above or refer to the council's website.

Agenda

1 Apologies

To receive apologies for absence

2 Declaration of interest

(Please note that it is the responsibility of individual members to declare an interest prior to the item if they arrive late for the meeting)

3 MC UK Alcohol Ltd Big Box Self Storage Vulcan Road

3 - 24

Purpose - Members are asked, in accordance with the delegation of licensing functions contained in the Norwich City Council Statement of Licensing Policy (Licensing Act 2003), to consider the application for the grant of a premises license in respect of MC UK Ltd Unit No 1628 Big Box Self Storage Vulcan Road Norwich NR6 6AQ following the receipt of a relevant representation.

Date of publication: **Monday, 20 October 2014**

Report to	Licensing sub committee 28 October 2014	Item
Report of	Head of citywide services Licensing Act 2003:	3
Subject	Application for grant of a Premises Licence – MC UK Alcohol Ltd Unit No1628 Big Box Self Storage Vulcan Road Norwich NR6 6AQ	

Purpose

Members are asked, in accordance with the delegation of licensing functions contained in the Norwich City Council Statement of Licensing Policy (Licensing Act 2003), to consider the application for the grant of a premises licence in respect of MC UK Alcohol Ltd Unit No1628 Big Box Self Storage Vulcan Road Norwich NR6 6AQ following the receipt of a relevant representation.

Recommendation

That members determine the application for the grant of a premises licence in respect of MC UK Alcohol Ltd Unit No1628 Big Box Self Storage Vulcan Road Norwich NR6 6AQ in accordance with the:

- Licensing Act 2003;
- Guidance issued under Section 182 of the Licensing Act 2003; and
- Norwich City Council Statement of Licensing Policy.

Corporate and service priorities

The report helps to meet the corporate priority of a safe and clean city and the service plan priority of protecting the interests of the public through the administration of the licensing function.

Financial implications

None.

Ward/s: All wards

Cabinet member: Councillor Harris – portfolio holder customer services

Contact officers

Ian Streeter, licensing manager

01603 212761

Background documents

None

Report

Background

1. The applicant is David Graves of 86 The Street Ashwellthorpe Wymondham NR16 1AA.
2. The application seeks to allow the licensable activities of the provision of late night refreshment and the sale by retail of alcohol.
3. The proposed standard days and hours for the licensable activities are:

Provision of late night refreshment

Friday	23:00 – 00:00
Saturday	00:00 – 10:00
Saturday	23:00 – 00:00
Sunday	00:00 – 10:00

Non-standard timings: Christmas Eve, Christmas Day, New Years Eve and Bank Holidays

the sale by retail of alcohol (for consumption off the premises)

Friday	23:00 – 00:00
Saturday	00:00 – 10:00
Saturday	23:00 – 00:00
Sunday	00:00 – 10:00

Non-standard timings: Christmas Eve – Christmas Day, New Years Eve, New Years Day and Bank Holidays (Sundays into Monday)

4. The opening hours requested are:

Friday	23:00 – 00:00
Saturday	00:00 – 10:00
Saturday	23:00 – 00:00
Sunday	00:00 – 10:00

5. The steps proposed to promote the licensing objectives together with a plan of the premises are attached at appendix A to the report.

Relevant representations

6. The responses from the Responsible Authorities are as follows:

Police – representations received (see appendix B).

Environmental Protection – no relevant representations received.

Fire Officer – no relevant representations received.

Planning Officer – no relevant representations received.

Area Child Protection Committee – no relevant representations received.

Trading Standards – no relevant representations received.

Primary Care Trust – no relevant representations received.

7. The applicant has agreed to add to his operating schedule all of the conditions contained in the police representation, but has not agreed to reduce the terminal hour for licensable activities to 04:00, as requested in the police representation.
8. No representations have been received from other interested parties.
9. A site map of the area identifying the application premises will be available at the meeting.

Norwich City Council Statement of Licensing Policy

10. Attached at appendix C are the elements of the City Council's local Licensing Policy which are considered to have a bearing upon the application:

National Guidance (issued under section 182 of the Licensing Act 2003)

11. Attached at appendix D are the elements of the National Guidance issued by the Secretary of State that are considered to have a bearing upon the application.

Summary

12. In determining the application with a view to promoting the licensing objectives the Sub-Committee must give appropriate weight to:
 - the steps that are appropriate to promote the licensing objectives (i.e. the prevention of crime and disorder; public safety; the prevention of public nuisance; and the protection of children from harm);
 - the representations (including supporting information) presented by all the parties;
 - the guidance issued under Section 182 of the Licensing Act 2003 (National Guidance); and
 - the Council's own statement of licensing policy.

13. The Sub-Committee must take such of the following steps as it considers appropriate for the promotion of the licensing objectives:
- Grant the application as asked;
 - Modify the conditions of the licence by altering or omitting or adding to them;
 - Reject the whole or part of the application
14. The Sub-Committee is asked to note that it may not modify the conditions or reject the whole or part of the application merely because it considers it desirable to do so. It must actually be appropriate in order to promote the licensing objectives.
15. The Sub-Committee is also reminded of the contents of appendices 2, 3, 4 and 5 of the local licensing policy (not re-produced in this report) which contain pools of model conditions relating to the four licensing objectives.

Section 18 of 19**LICENSING OBJECTIVES**

Describe the steps you intend to take to promote the four licensing objectives:

a) General – all four licensing objectives (b,c,d,e)

List here steps you will take to promote all four licensing objectives together.

Strict THINK (25) ID Policy to ID anyone we believe is under the age of 25, And refuse sale if they have no Photographic Identification.

Only sell alcohol to people at there House.

Refuse Sale to anyone we believe is too drunk or disorderly.

Refuse sale to any persons we believe may be purchasing the alcohol of behalf of minors.

Continued from previous page...

Delivery of Alcohol will be for individuals to consume at there home address. Sale will be refused to anyone we believe is too drunk or Disorderly.

c) Public safety

The delivery of alcohol to peoples home reduces the number of people in late night clubs and on the street - offering an alternative service, than having to deal with drunken people of an offensive nature in late night shops.

Refusing sale to anyone we believe to be drunk or of a violent nature.

d) The prevention of public nuisance

Refusing Sale of alcohol to people that are Too drunk and or a violent nature.

Delivery of alcohol will be to Peoples houses only.

e) The protection of children from harm

Strict THINK (25) ID Policy to ID anyone we believe is under the age of 25, And refuse sale if they have no Photographic Identification.

Refuse sale to any persons we believe may be purchasing the alcohol of behalf of minors.

LICENSING OFFICE

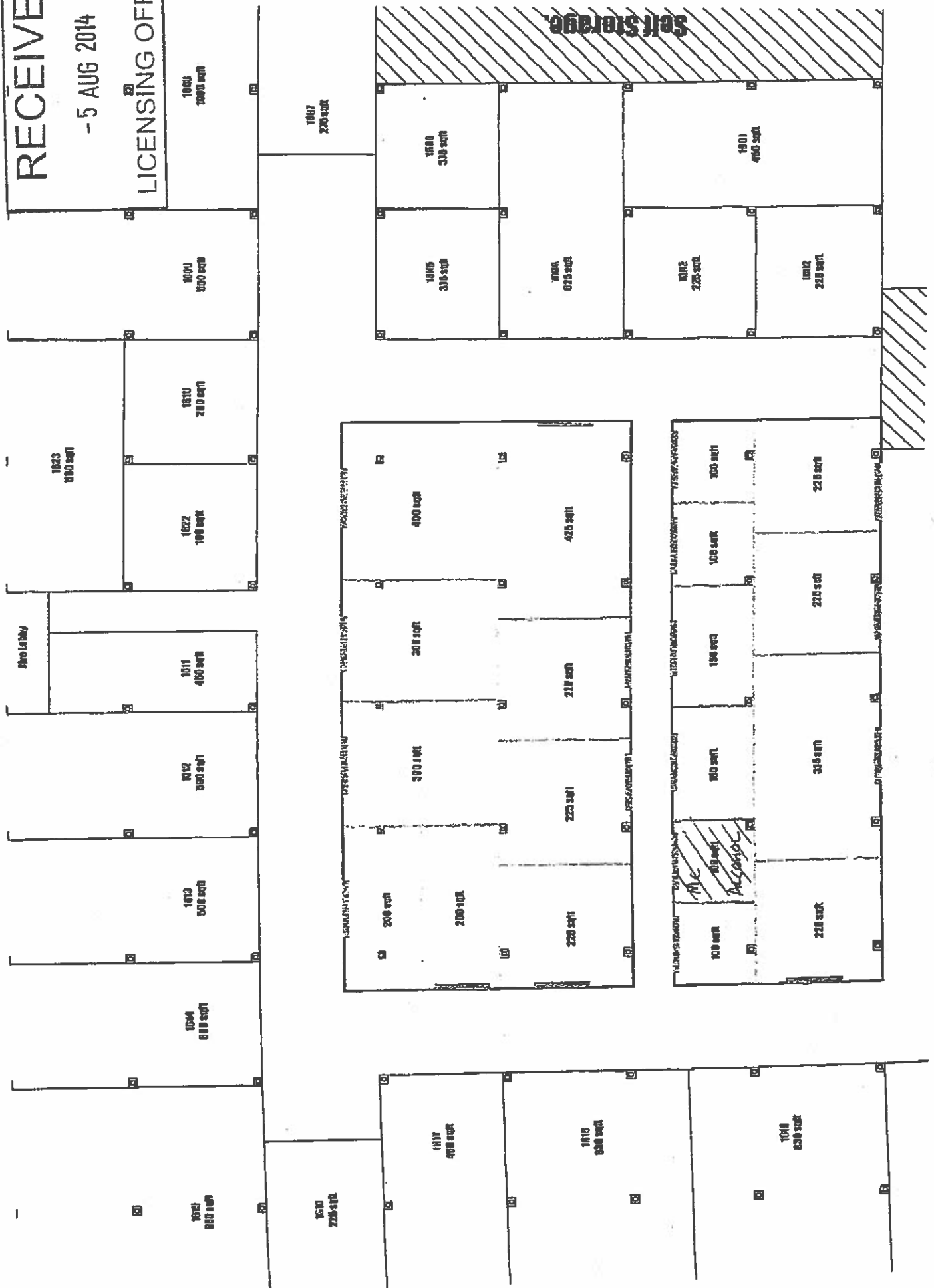



NORFOLK

CONSTABULARY

Our Priority is You

Mr Ian Streeter
Licensing Manager
Norwich City Council
St Peters Street
Norwich

26th September 2014

Dear Sir

The Licensing Team
Bethel Street Police Station
Norwich
Norfolk
NR2 1NN

Tel: 01603 276020

Fax: 01603 276025

Email: licensingteam@norfolk.pnn.police.uk

www.norfolk.police.uk

Non-Emergency Tel: 0845 456 4567

Letter of Representation – MC UK Alcohol Ltd

I can confirm that Police have received a copy of the premises licence application for Big Box Self Storage, Vulcan Road Norwich.

The purpose of this application is to allow for the sale of alcohol on Fridays 2300hrs until 10am on Saturdays and then 2300 hrs on Saturday nights until 10am Sunday morning.

Firstly there is a concern that the application does not specify the unit number of the address at the Big Box Storage premises. This unit number will need to be specified as soon as possible.

The intention of this licence is for the applicant to operate a late night alcohol delivery service so that customers can consume alcohol at their residential addresses. There is a concern that these operations can contribute to anti-social behaviour within neighbourhoods and those who would have ceased drinking alcohol then have the opportunity to continue drinking further potentially causing an increase to crime and disorder.

There is a concern with the hours requested for the sale of alcohol therefore in order to reduce the risk of crime and disorder, the Police request that there is a restriction so that all alcohol sales cease at 0400 hrs. It is felt that after this time, this could cause a significant impact. Police analytical material shows that crime increases after 0300 hrs.

I have been informed that the applicant requires the facility to offer alcohol throughout the night to support business plan however by allowing this would undermine all the licensing objectives in addition to increasing public nuisance and risking the health of those consuming.

In addition to the potential for incidents of crime and disorder, the facility is allowing patrons to continue partying and drinking for longer when these would have previously ceased. This could also have a detrimental effect to residents with vehicles arriving to deliver the alcohol and from the patrons.

This request to restrict the hours until 0400 hrs reflects the availability of alcohol within the heart of the night time economy and in line with the proposed Early Morning Restriction Order.

The Police have no previous experience or history of the operator, therefore we are unable to prove how well and responsible the business will be run. It is requested that the licensing committee grant the licence only until 0400 hrs as a maximum until evidence of the management and reassurance that no impact is caused can be given.

The applicant has included proposed conditions to be added to the premises licence such as refusing sales to drunks however these conditions are already within the Licensing Act 2003. The measures proposed are felt to be insufficient to safeguard the running of the business.

The Police request that the following conditions are added:

- **There shall be no sales of alcohol to persons visiting the premise**
- **The Premises licence Holder will nominate a manager to be located in Norwich who will be directly contactable and enable access to the premises during all operating hours with immediate effect of the business operating.**
- **The name, address, contact telephone numbers and verification of age of customer shall be taken at point of ordering prior to dispatching goods to the customers address**
- **Records of all sales made and refused sales shall be kept and made available to the Police and Licensing Authority on request.**
- **Each driver employed to deliver age restricted produces shall wear a body worn video camera. All transactions and deliveries involving age restricted products shall be recorded both in sound and on video at the point of delivery. All recorded footage shall be retained for at least 31 days and made available to Police or Licensing Authority on request.**
- **Cash obtained from sales shall be immediately transferred into a safe within the delivery vehicle. Once the total amount reaches a limit of £250 cash, the driver shall return to the premises and transfer the cash from the vehicle to a secure safe contained within the premises.**
- **No deliveries shall be left without a signature**
- **The Website will contain information to customers that orders can only be taken from patrons over 18 and proof of age requirements.**
- **Records of staff training will be kept on site and available to Police or Licensing Authority on request.**
- **Alcohol shall not be supplied to public places, an address must be provided.**
- **All obligatory requests made relating to the security of the premises within the Police Crime Reduction Officer Report are carried out prior to the company trading.**
- **CCTV to be installed at the premises and for recordings to be kept for a minimum of 28 days.**
- **Credible photographic proof of age evidence such as passport or driving licence will be requested for the recipient for anyone who appears to be under the age of 25.**

With the amendment of hours for the sale of alcohol until 0400 hrs and the conditions proposed to be attached to the premises licence, the Police will have no objections.

Yours faithfully,

Michelle Bartram
Licensing Officer

Local Policy considerations

1.0 Introduction

1.4 The 2003 Act requires the council to carry out its various licensing functions so as to promote the four licensing objectives. These are:

- The Prevention of Crime and Disorder
- Public Safety
- The Prevention of Public Nuisance
- The Protection of Children from Harm

1.5 The 2003 Act also requires that the Council publishes a 'Statement of Licensing Policy' that sets out the policies the Council will generally apply to promote the Licensing Objectives when making decisions on applications made under the Act.

2.0 Consultation and Links to other Policies and Strategies

2.7 So far as possible, the council will avoid duplication with other regulatory regimes, and will not to use its powers under the Licensing Act 2003 to achieve outcomes that can be achieved by other legislation and other enforcement agencies. As an example, the council will not seek to impose fire safety conditions that may duplicate any requirements or prohibitions that could be imposed under the Regulatory Reform (Fire Safety) Order 2005.

3.0 Applications for Licences

3.2 Applicants must address the four licensing objectives in their operational plan. The operating plan must have regard to the nature of the area where the premises are situated, the type of premises, the licensable activities to be provided, operational procedures and the needs of the local community. The operating schedule must demonstrate how the premises will be "good neighbours" both to residents and to other venues and businesses.

3.3 Applicants must provide evidence that suitable and sufficient measures, as detailed in their operating schedule, will be implemented and maintained, relevant to the individual style, location and characteristics of their premises and activities. They must also indicate if additional measures will be taken on an occasional or specific basis, such as when a special event or promotion is planned, which is, for example, likely to attract larger audiences.

4.0 Representations

4.1 "Responsible Authorities" (see Appendix 7) will be asked to consider all applications and to make representations to the council, if they relate to the promotion of the four licensing objectives and particularly in respect of applications which, might be regarded as contentious. Representations must be

evidentially based and the organisation should attend any hearing when the application is being considered. Representations can be made in opposition to, or in support of, an application.

- 4.2 The council will consider all representations from any “Interested Party” (see Appendix 7), or their representative, which should preferably be evidentially based and supported by attendance at any hearing at which the application is being considered.
- 4.3 A representation, will only be accepted by the council if it is ‘relevant’, ie it must relate to the likely effect of granting the licence on the promotion of at least one of the four licensing objectives. Representations, that are regarded as being frivolous or vexatious, will not be considered, and in the case of a review of a licence, any representation which is regarded as repetitious, will also not be considered. A decision as to whether a representation is frivolous, vexatious or repetitive will be made by an officer of the council.
- 5.0 Conditions attaching to Licences
- 5.1 Where relevant representations are made, the council will make objective judgments as to whether conditions may need to be attached to the premises licence to secure achievement of the licensing objectives. Any conditions arising as a result of representations will primarily focus on the direct impact of the activities taking place at licensed premises, on those attending the premises, and members of the public living, working or engaged in normal activity in the area concerned, and will cover matters that are within the control of individual licensees.
- 5.2 All applications will be considered on an individual basis and any condition attached to such a licence, will be tailored to each individual premises, in order to avoid the imposition of disproportionate or burdensome conditions on those premises. Therefore, mandatory conditions, will only be imposed where they are appropriate for the promotion of the licensing objectives.
- 8.0 The Impact of Licensed Premises
- 8.1 When considering whether any licensed activity should be permitted, and a relevant representation has been received, the likelihood of it causing unacceptable adverse impact will be assessed by taking into account relevant matters including:
- the type of use, the number of customers likely to attend the premises and the type of customers at the time of the application;
 - the proposed hours of operation;
 - the level of public transport accessibility for customers either arriving or leaving the premises and the likely means of public or private transport that will be used by the customers;
 - the means of access to the premises including the location of customer entrances and exits;
 - the provision of toilet facilities;
 - the frequency of the licensable activity.

With any adverse impact it may be possible to take steps to mitigate or prevent the impact and if such measures are reliable an activity may be licensed.

13.0 Management of Licensed Premises

- 13.1 Within the operating schedule for premises from which alcohol will be sold, with the exception of qualifying community premises, a premises supervisor must be designated (designated premises supervisor) and such person must be in possession of a current personal licence. The licensing authority will normally expect the designated premises supervisor [DPS] to have been given the day to day responsibility for running the premises by the premises licence holder and, as such, would normally be present on the licensed premises on a regular basis. In addition to the DPS holding a personal licence, the licensing authority would strongly encourage the DPS to undergo additional training and to have experience commensurate with the nature and style of entertainment provided and the capacity of the premises.
- 13.2 The act does not require a DPS or any other personal licence holder to be present on the premises at all times when alcohol is sold. However, the DPS and the premises licence holder remain responsible for the premises at all times and have a duty to comply with the terms of the licensing act and any conditions, including the matters set out in the premises' operating schedule, in order to promote the licensing objectives. To that end, the licensing authority will be mindful of the guidance issued by the secretary of state, which recommends that a personal licence holder/DPS gives specific written authorisations to those individuals they are authorising to retail alcohol. Although written authorisation is not a requirement of the act and the designated premises supervisor/personal licence holder remain ultimately responsible for ensuring compliance with the act and licensing conditions, this action could assist in demonstrating due diligence should any issues arise with regard to enforcement.

The licensing authority will therefore expect that where the personal licence holder/DPS does not have the premises under their immediate day to day control, written authorisations will be issued to staff acting on their behalf, such authorisations being made available for inspection by a responsible Officer of the licensing authority or the police upon request.

LICENSING OBJECTIVES

20.0 Objective - Prevention of Crime and Disorder

- 20.1 Section 17 of the Crime and Disorder Act 1998 introduced a wide range of measures for preventing crime and disorder and imposed a duty on the City Council, and others, to consider crime and disorder reduction in the exercise of all their duties. The Licensing Act 2003 reinforces this duty for local authorities.
- 20.2 The promotion of the licensing objective, to prevent crime and disorder, places a responsibility on licence holders to become key partners in achieving this objective. Applicants will be expected to demonstrate in their operating schedule that suitable and sufficient measures have been identified and will be implemented and maintained to reduce or prevent crime and disorder on and in the vicinity of

their premises, relevant to the individual style and characteristics of their premises and the licensable activities at those premises.

- 20.3 When addressing the issue of crime and disorder, the applicant should demonstrate that all those factors that impact on crime and disorder have been considered. These include:

Underage drinking

Drunkenness on premises

Public drunkenness

Keeping Illegal activity like drug taking and dealing, offensive weapons and sales of contraband or stolen goods away from the premises.

Preventing disorderly and potentially violent behaviour on and outside the premises.

Reducing Anti-social behaviour and Disorder inside and outside the premises

Litter

Unauthorised advertising

Protecting people and property from theft, vandalism and assault

Guard against glasses and bottles being used as weapons or causing accidents.

- 20.4 The following examples of control measures are given to assist applicants who may need to take account of them in their operating schedule, having regard to their particular type of premises and/or licensable activities:

Effective and responsible management of premises;

Training and supervision of staff;

Employ sufficient numbers of staff to keep numbers down of people awaiting service;

Provide sufficient seating for customers;

Patrols of staff around the premises;

Ensure sufficient lighting and visibility, removing obstructions if necessary, to discourage illegal activity;

Introduce an entry policy – making people aware of it – and apply it consistently and fairly;

Implement a search policy to prevent drugs, offensive weapons etc being brought onto the premises;

Implement effective management of entrance queues – incorporating barriers if necessary;

Adoption of best practice guidance e.g. Safer Clubbing, the National Alcohol Harm Reduction Strategy Toolkit, Minor Sales Major Consequences, Clubbing against Racism and other voluntary codes of practice, including those relating to drinks promotions e.g. The Point of Sale Promotions published by the British Beer and Pub Association (BBPA), Security in Design published by BBPA and Drugs and Pubs, published by BBPA;

Acceptance of accredited 'proof of age' cards e.g. Portman proof of age cards, Citizencard, Connexions Card and/or 'new type' driving licences with photographs, or passports;

Provision of effective CCTV in and around premises;

Employment of Security Industry Authority licensed door staff to manage the door and minimize disorder;

Ensure glasses are collected on an on going basis, make regular inspections for broken glass and clear up;

Provision of toughened or plastic drinking vessels and bottles;

Provision of 'bottle bins' inside the premises and near exits;

Provision of secure, deposit boxes for confiscated items i.e. Operation Enterprise Drug and Weapon Amnesty Safe's;

Information displayed for staff and customers on Drug Awareness including the 'spiking' of drinks with drugs;

Provision of litterbins and other security measures, such as lighting, outside premises;

Membership of local 'Pubwatch' schemes or similar accreditation schemes or organizations ie Operation Enterprise;

Responsible advertising;

Distribution of promotional leaflets, posters etc;

Drug Seizure Kits (available from Norfolk Police Operation Enterprise);

Member of the 'NiteLink' radio scheme;

Working in partnership with the SOS Bus scheme;

Ban known offenders and share information with other licensed premises in the area;

Implement a dispersal policy;

Introduce a 'closed door' policy, with attendance prohibited for new customers 2-3 hours before licensable activities finish;

26. Objective – protection of children from harm

- 26.1 The council will consult with the appropriate area child protection committee for consideration of all applications for licences.
- 26.2 With a view to the promotion of the licensing objective relating to the protection of children from harm the council will work closely with the police and trading standards authority to ensure the appropriate enforcement of the law, especially relating to the sale and supply of alcohol products to children (for Minor Sales Major Consequences information please contact trading standards on 0844 800 8013 trading.standards@norfolk.gov.uk).
- 26.3 Applicants should be aware that the protection of children from harm includes the protection of children from moral, psychological and physical harm and this includes the protection of children from exposure to strong language, sexual expletives and gambling. In certain circumstances children are more vulnerable

and their needs will require special consideration. This vulnerability includes their susceptibility to suggestion, peer group influences, inappropriate example, the unpredictability of their age and their lack of understanding of danger.

- 26.4 There should be no presumption of giving children access nor any presumption of preventing their access to licensed premises. Where no licensing restriction is necessary, the admission of children will remain entirely a matter for the discretion of the individual licensee or club, or person who has given a temporary event notice.
- 26.5 Applicants must ensure that children will not be allowed access into premises when licensable activities involving eg topless female bar staff, striptease, lap, table or pole dancing, performances involving feigned violence or horrific incidents, feigned or actual sexual acts or fetishism, or entertainment involving strong and offensive language. The council has given particular consideration to the types of entertainment referred to above, and has included within this policy their expectations of applicants in section A, paragraph 17.
- 26.6 Applicants will be expected to demonstrate in their operating schedule that suitable and sufficient measures have been identified and will be implemented and maintained to protect children from harm, relevant to the individual style and characteristics of their premises and the licensable activities for which a licence is being sought.**
- 26.7 While children may be adequately protected from harm by the action taken to protect adults, they may also need special consideration and no policy can anticipate every situation. **When addressing the issue of protecting children from harm, the applicant must demonstrate that those factors that may particularly impact on harm to children have been considered.** These include:
- where entertainment or services of an adult or sexual nature are commonly or regularly provided
 - where there have been convictions of members of the current staff at the premises for serving alcohol to minors or with a reputation for underage drinking
 - where there has been a known association with drug taking or dealing
 - where there is a strong element of gambling on the premises
 - where the supply of alcohol for consumption on the premises is the exclusive or primary purpose of the services provided at the premises.
- 26.8 The council commends the Portman Group code of practice on the naming, packaging and promotion of alcoholic drinks. The code seeks to ensure that drinks are packaged and promoted in a socially responsible manner and only to those who are 18 years or older. **The council will expect all licensees to agree not to replenish their stocks following notification of a retailer alert bulletin by the Portman Group in relation to any product that is in breach of that code. Commitment to that code should be included in operating schedules.**
- 26.9 The following examples of control measures are given to assist applicants and are considered to be amongst the most essential that applicants should take account

of in their operating schedule, having regard to their particular type of premises and/or activities:

- Effective and responsible management of premises.
- Provision of a sufficient number of people employed or engaged to secure the protection of children from harm.
- Appropriate instruction, training and supervision of those employed or engaged to secure the protection of children from harm.
- Adoption of best practice guidance (eg Minor Sales Major Consequences).
- Ensure that all drinks containers carry a price tag or other sticker that identifies your premises. This will be a useful tool for working with authorities to tackle underage drinking if problems arise.
- Limitations on the hours when children may be present, in all or parts of the premises.
- Limitations or exclusions by age when certain activities are taking place.
- Imposition of requirements for children to be accompanied by an adult.
- Train staff to deal with – and be vigilant about – potentially harmful situations, eg children in the presence of adults who are excessively drunk.
- Acceptance of accredited proof of age cards and/or new type driving licences with photographs, or passports.
- Measures to ensure children do not purchase, acquire or consume alcohol.
- Measures to ensure children are not exposed to incidences of violence or disorder.

These examples can be adopted in any combination.

26.10 In the case of film exhibitions, licence and certificate holders and those who have given notice of a temporary event within the terms of the 2003 Act should implement measures that restrict children from viewing restricted films classified according to the recommendations of the British Board of Film Classification or the council.

26.11 In premises where there may be children unaccompanied by adults any supervisors must have undergone appropriate checks through the Criminal Records Bureau.

SECTION E - Hours of Trading

30.2 In determining its policy on the hours of trading, the council has given full consideration to those parts of the secretary of state's guidance to the act which relate to hours of trading.

“Where there are objections to an application to extend the hours during which licensable activities are to be carried on and the licensing authority determines that this would undermine the licensing objectives, it may reject the application or grant it with appropriate conditions and/or different hours from those requested.”

30.7 Consideration will always be given to an applicant's individual case and if the matter of trading hours has been raised in a representation, the council will take into account any proposals the applicant has to minimise the risk of nuisance or disorder being caused or exacerbated by customers departing from the premises.

It is however, unlikely that statements such as the premises being well-managed, or that the applicant is of good character or that the style of the premises is intended and likely to attract a discerning clientele, will alone be sufficient to demonstrate that restrictions on hours of trading should not be applied.

APPENDIX D

National Guidance

(issued under section 182 of the Licensing Act 2003)

CRIME AND DISORDER

2.1 The steps any licence holder or club might take to prevent crime and disorder are as varied as the premises or clubs where licensable activities take place. Licensing authorities should therefore look to the police as the main source of advice on these matters. They should also seek to involve the local Community Safety Partnership (CSP).

2.4 The essential purpose of the licence or certificate in this context is to regulate behaviour on and access to premises where this relates to licensable activities and the licensing objectives. Conditions attached to licences cannot seek to manage the behaviour of customers once they are beyond the direct management of the licence holder and their staff or agents, but can directly impact on the behaviour of customers on, or in the immediate vicinity of, the premises as they seek to enter or leave. Examples of measures which may encourage swift and effective dispersal from licensed premises include quietening down periods at the end of the night, security training in reminding patrons to leave quietly and signage on the premises reminding people of this.

2.5 Licence conditions should not replicate offences that are set out in the 2003 Act or other legislation. For example, a condition that states that a licence holder shall not permit drunkenness and disorderly behaviour on the premises would be superfluous because this is already a criminal offence. A condition that states that a licence holder shall not permit the sale of controlled drugs on the premises would be similarly superfluous.

2.6 Conditions are best targeted on deterrence and preventing crime and disorder. For example, where there is good reason to suppose that disorder may take place, the presence of closed-circuit television (CCTV) cameras both inside and immediately outside the premises can actively deter disorder, nuisance, anti-social behaviour and crime generally. Some licence holders may wish to have cameras on their premises for the prevention of crime directed against the business itself, its staff, or its customers. But any condition may require a broader approach, and it may be appropriate to ensure that the precise location of cameras is set out on plans to ensure that certain areas are properly covered and there is no subsequent dispute over the terms of the condition.

2.7 Similarly, the provision of requirements for door supervision may be appropriate to ensure that people who are drunk, drug dealers or people carrying firearms do not enter the premises and ensuring that the police are kept informed.

2.8 Radio links and ring-round phone systems allow managers of premises and clubs to communicate instantly with the police and facilitate a rapid response to any disorder which may be endangering the customers and staff on the premises. The inclusion of

these systems should be considered an appropriate condition for public houses, bars and nightclubs operating in city and town centre leisure areas with a high density of licensed premises.

2.9 However, while this may be appropriate and effective in certain parts of a licensing authority's area, it may be less effective or even inappropriate in others. Licensing authorities must remember that only appropriate conditions, which are within the control of the licence holder or club, may be imposed.

2.10 A condition must also be capable of being met. For example, while beer glasses may be available in toughened glass, wine glasses may not. Licensing authorities should carefully consider conditions of this kind to ensure that they are not only appropriate but both practical and achievable. Further guidance on determining whether a condition is appropriate is given in Chapter 10 of this guidance.

2.16 Conditions on a premises licence are important in setting the parameters within which premises can lawfully operate. The use of wording such as "must", "shall" and "will", is encouraged. Conditions on licences must:

- be precise and enforceable;
- be unambiguous;
- not duplicate other statutory provisions;
- be clear in what they intend to achieve; and,
- be appropriate, proportionate and justifiable.

PROTECTION OF CHILDREN FROM HARM

2.41 The protection of children from harm includes the protection of children from moral, psychological and physical harm. This includes not only protecting children from the harms associated with alcohol but also wider harms such as exposure to strong language and sexual expletives (for example, in the context of exposure to certain films or adult entertainment).

2.42 The Government believes that it is completely unacceptable to sell alcohol to children. Conditions relating to the access of children where alcohol is sold and which are appropriate to protect them from harm should be carefully considered. Moreover, conditions restricting the access of children to premises should be strongly considered in circumstances where:

- adult entertainment is provided;
- a member or members of the current management have been convicted for serving alcohol to minors or with a reputation for allowing underage drinking (other than in the context of the exemption in the 2003 Act relating to 16 and 17 year olds consuming beer, wine and cider when accompanied by an adult during a table meal);
- it is known that unaccompanied children have been allowed access;
- there is a known association with drug taking or dealing; or
- in some cases, the premises are used exclusively or primarily for the sale of alcohol for consumption on the premises.

2.43 It is also possible that activities, such as adult entertainment, may take place at certain times on premises but not at other times. For example, premises may operate as a café bar during the day providing meals for families but also provide entertainment with a sexual content after 8.00pm.

2.44 Applicants must be clear in their operating schedules about the activities and times at which the events would take place to help determine when it is not appropriate for children to enter the premises. Consideration should also be given to the proximity of premises to schools and youth clubs so that applicants take appropriate steps to ensure that advertising relating to their premises, or relating to events at their premises, is not displayed at a time when children are likely to be near the premises.

2.45 Licensing authorities and responsible authorities should expect applicants, when preparing an operating schedule or club operating schedule, to set out the steps to be taken to protect children from harm when on the premises.

2.46 Conditions, where they are appropriate, should reflect the licensable activities taking place on the premises. In addition to the mandatory condition regarding age verification, other conditions relating to the protection of children from harm can include:

- restrictions on the hours when children may be present;
- restrictions on the presence of children under certain ages when particular specified activities are taking place;
- restrictions on the parts of the premises to which children may have access;
- age restrictions (below 18);
- restrictions or exclusions when certain activities are taking place;
- requirements for accompanying adult (including for example, a combination of requirements which provide that children under a particular age must be accompanied by an adult); and
- full exclusion of people under 18 from the premises when any licensable activities are taking place.

PROPOSED CONDITIONS

10.6 The conditions that are appropriate for the promotion of the licensing objectives should emerge initially from the risk assessment carried out by a prospective licence or certificate holder, which they should carry out before making their application for a premises licence or club premises certificate. This would be translated into the steps recorded in the operating schedule or club operating schedule, which must also set out the proposed hours during which licensable activities will be conducted and any other hours during which the premises will be open to the public.

10.7 In order to minimise problems and the necessity for hearings, it would be sensible for applicants and clubs to consult with responsible authorities when schedules are being prepared. Proper liaison may avoid the need for representations.

10.8 Conditions should be appropriate, proportionate and justifiable in meeting the licensing objectives. They should be written in a prescriptive format and be readily understood and enforceable.

10.9 It is also not acceptable for licensing authorities to simply replicate the wording from an applicant's operating schedule. A condition should be interpreted in accordance with the applicant's intention. Conditions should be appropriate for the promotion of the licensing objectives and easily enforceable.

CONSISTENCY WITH STEPS DESCRIBED IN OPERATING SCHEDULE

10.10 The 2003 Act provides that where an operating schedule or club operating schedule has been submitted with an application and there have been no relevant representations made by responsible authorities or any other person, the licence or certificate must be granted subject only to such conditions as are consistent with the schedule accompanying the application and any mandatory conditions required under the 2003 Act.

10.11 Consistency means that the effect of the condition should be substantially the same as that intended by the terms of the operating schedule. If conditions are broken, this may lead to a criminal prosecution or an application for a review and it is extremely important therefore that they should be expressed on the licence or certificate in unequivocal and unambiguous terms. The duty imposed by conditions on the licence holder or club must be clear to the licence holder, club, enforcement officers and the courts.

IMPOSED CONDITIONS

10.12 The licensing authority may not impose any conditions unless its discretion has been engaged following receipt of relevant representations and it is satisfied as a result of a hearing (unless all parties agree a hearing is not necessary) that it is appropriate to impose conditions to promote one or more of the four licensing objectives.

10.13 It is possible that, in certain cases, where there are other legislative provisions which are relevant and must be observed by the applicant, no additional conditions are appropriate to promote the licensing objectives.

Proportionality

10.14 The 2003 Act requires that licensing conditions should be tailored to the size, type, location and characteristics and activities taking place at the premises concerned. Conditions should be determined on a case-by-case basis and standardised conditions which ignore these individual aspects should be avoided.

10.15 Licensing authorities and other responsible authorities should be alive to the indirect costs that can arise because of conditions. These could be a deterrent to holding events that are valuable to the community or for the funding of good and important causes. Licensing authorities should therefore ensure that any conditions they impose are only those which are appropriate for the promotion of the licensing objectives. Consideration should also be given to wider issues such as conditions already in place that address the potential negative impact on the promotion of the licensing objectives

and the track record of the business. The physical safety of those attending such events should remain a primary objective.

THE NEED FOR LICENSED PREMISES

13.18 There can be confusion about the difference between the “need” for premises and the “cumulative impact” of premises on the licensing objectives, for example, on crime and disorder. “Need” concerns the commercial demand for another pub or restaurant or hotel and is a matter for the planning authority and for the market. This is not a matter for a licensing authority in discharging its licensing functions or for its statement of licensing policy.

