

## Report for Resolution

<b>Report to</b>	Norwich Highways Agency Committee 25 September 2008	<b>Item</b>
<b>Report of</b>	Head of Transportation and Landscape	<b>8</b>
<b>Subject</b>	Bowthorpe Road Speed Management Scheme - Objections to Traffic Regulation Order	

---

### Purpose

This report informs members of the results of public consultation on the Bowthorpe Road Speed Management Scheme.

### Recommendations

The Committee is recommended to approve the following proposals as shown in appendix 3:

- (1) Zebra crossing near the junction of Gipsy Lane, plus re-aligning the Gipsy Lane junction;
- (2) right turn cycle lane from Bowthorpe Road into Gipsy Lane;
- (3) vehicle Activated 30mph signs on approaches to Zebra crossing
- (4) relocation of Vehicle Activated sign on approach to Earlham Green Lane junction;
- (5) traffic island and right turn pocket for cyclists at Earlham Green Lane junction.

### Financial Consequences

The financial consequences of this report are that the Local Transport Plan has allocated £65,000 for this scheme

### Strategic Objective/Service Priorities

The report helps to achieve the corporate objective “Strong and prosperous city – working to improve quality of life for residents, visitors and those who work in the city now and in the future” and the service plan priority of implementing the Local Transport Plan.

### Contact Officers

Phil Slater, Principal Technical Officer	01603 213426
Joanne Deverick, Transportation Manager	01603 213430

### Background Documents

None

# Report

## Introduction

1. Over the past few years, local residents and City and County Members have asked for speed management measures in Bowthorpe Road between Farrow Road and Earlham Green Lane.
2. A petition was presented to the May 2007 meeting of this Committee expressing concerns about the Bowthorpe Road / Earlham Green Lane junction.
3. This section of Bowthorpe Road has been identified as a priority for traffic management measures, with a total of 21 personal injury accidents over a 5 year period.
4. Funding is available from the Norfolk Local Transport Plan.

## The Site

5. Bowthorpe Road is a key link in the City's network, and is now a main access route for Fire engines since the new Fire Station was constructed on the old Bowthorpe School site. It is also a bus route and a popular cycle route.
6. Speed humps and cushions are therefore not considered appropriate for this road, so the proposals include interactive speed signs and measures to improve safety for pedestrians and cyclists as well as to encourage slower traffic speeds.
7. A Zebra crossing was installed by the junction of Cadge Road in February 2007, funded by the development at the Bowthorpe School site.
8. Residents of Fieldview have complained about the problem of restricted visibility and the speed of vehicles on Bowthorpe Road which makes it difficult to exit their cul-de-sac.

## Proposals

9. The scheme is shown as appendix 1 and consists of:
  1. Vehicle activated 30mph flashing speed signs either side of the Ivy Road junction
  2. Extending the double yellow lines at the Fieldview junction, to improve visibility for emerging traffic
  3. Installing a pedestrian refuge near the Gypsy Lane junction, with associated road widening
  4. Providing a right turn lane for cyclists from Bowthorpe Road into Gypsy Lane
  5. Re-locating an existing vehicle activated 30mph sign to a position on the

approach to the shopping centre near Earlham Green Lane

6. Providing centre hatching near the Earlham Green Lane junction, and a central island to create a cycle crossing point
10. Consultation took place on these proposals in July 2008, and the traffic regulation order for the extra waiting restrictions at the Fieldview junction was advertised. The closing date for objections was 12 August 2008.

### **Results of Public Consultation**

11. Thirty-one letters or emails were received by the closing date, and are summarised in Appendix 2. This comprised of:
  - 26 objections to the proposed double yellow lines outside the shop at 308 Bowthorpe Road
  - 1 objection to the proposed road widening outside nos. 322 to 328 Bowthorpe Road
  - 3 in favour of the proposals

### **Assessment and Revised Proposals**

#### **Fieldview Junction**

12. A large number of objections have been received to the proposed extension of the double yellow lines at Fieldview on the grounds that preventing vehicles parking outside the shop may lead to customers going elsewhere, resulting in the shop's closure. The store has recently lost the post office. There were 3 letters of support for the proposal and Councillor Ramsay has stated that several other residents of Fieldview also support it.
13. Some objectors have stated that 2 of the trees restrict visibility of oncoming traffic more than parked vehicles, and should be removed. They also consider that parked vehicles help to keep vehicle speeds down.
14. The City Council would not wish to lose any trees on Bowthorpe Road as they form an attractive tree lined corridor along this busy traffic route. In view of the strength of feeling expressed about the viability of the shop, it is proposed that these markings are not introduced.

#### **Gipsy Lane Junction**

15. There were no adverse comments about the refuge, but the resident of 326 Bowthorpe Road objects to the road widening on the grounds that it will move traffic closer to the house with consequential increase in noise and a reduction in visibility around the bend.
16. A safety audit carried out on the scheme has raised some safety concerns about the location of the refuge in terms of visibility of and by pedestrians waiting to cross. Also, the proposed road widening to accommodate a refuge will require expensive diversions to public utility apparatus.

17. It is therefore proposed that a Zebra crossing is constructed instead of a refuge, and relocated further east to improve visibility. This will not require any road widening on Bowthorpe Road but would require the re-alignment of the Gipsy Lane junction.
18. The recent closure of the post office at 308 Bowthorpe Road will result in more people having to travel to the post office the Five Ways shopping centre. A Zebra crossing will therefore help people to cross Bowthorpe Road to walk down Gipsy Lane. The re-alignment of the Gipsy Lane junction will narrow down the junction and help to reinforce the fact that this is a cul-de-sac.

### **Vehicle Activated Signs**

19. One objector has suggested that the flashing signs would be better placed either side of the Fieldview junction than the Ivy Road junction.
20. It is proposed that the signs are re-located to the approaches to the proposed Zebra crossing, in order encourage slower speeds and provide additional warning of the crossing ahead. This would also cover the traffic approaching the Fieldview junction travelling eastwards.

### **Earlham Green Lane Junction**

21. Following the petition submitted by residents about the problems at this location, a scheme to 'square up' the junction was considered but the number of accidents does not warrant the expenditure required.
22. The creation of a right turn pocket protected by a traffic island will assist cyclists joining Bowthorpe Road, and the centre hatching combined with the relocating of the vehicle activated sign will help to encourage slower speed on the approach to this junction.
23. The revised proposals are shown as appendix 3

# APPENDIX 1

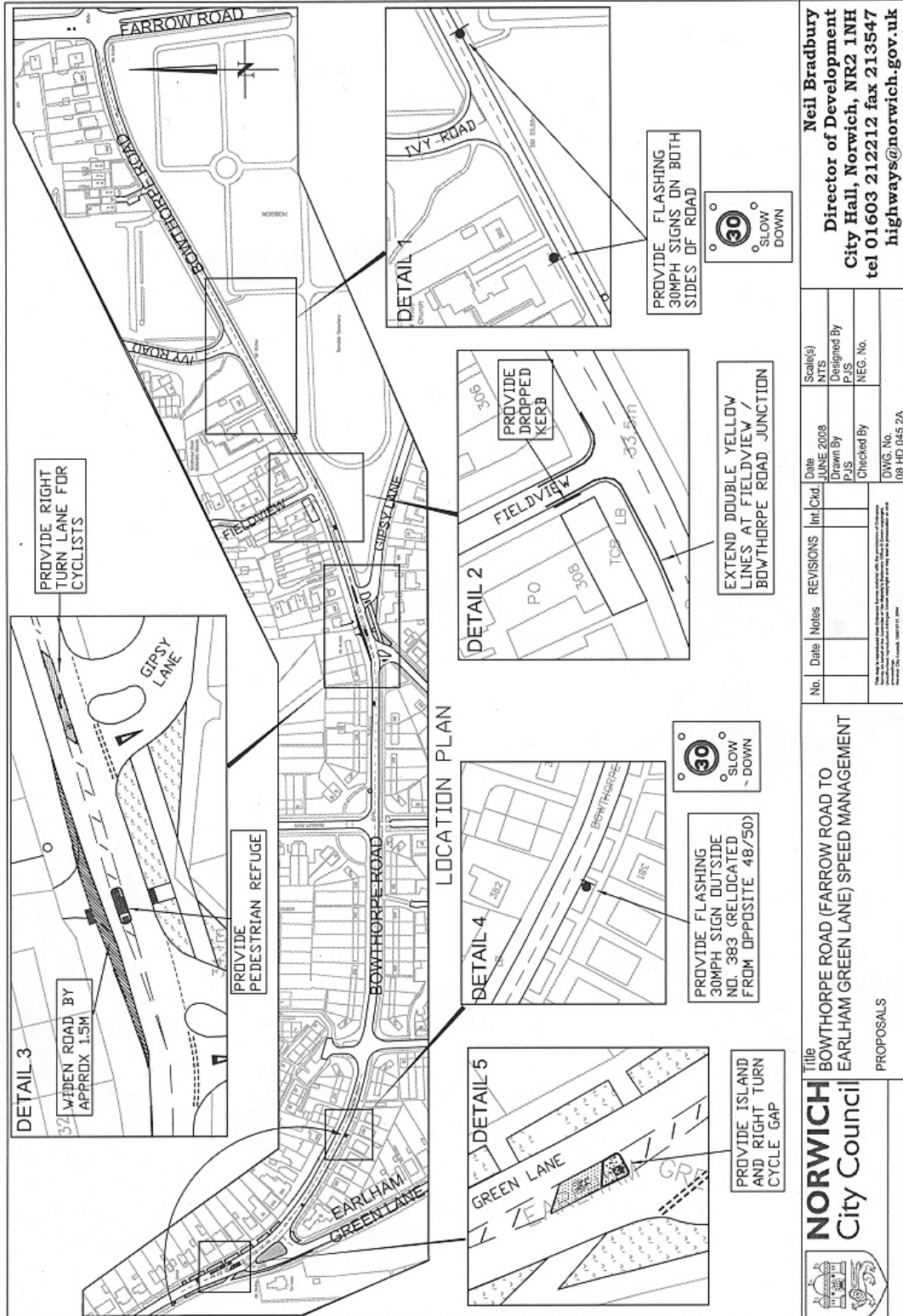

**Neil Bradbury**  
**Director of Development**  
 City Hall, Norwich, NR2 1NH  
 tel 01603 212212 fax 213547  
 highways@norwich.gov.uk

No.	Date	Notes	REVISIONS	Int.Ckd.	Date	Scale(s)
					JUNE 2008	NTS
					Drawn By	Designed By
					PJS	PJS
					Checked By	NEG. No.
					DWG. No.	
					09 HD 045 2A	

**NORWICH** City Council  
 Title: BOWTHORPE ROAD (FARROW ROAD TO EARLHAM GREEN LANE) SPEED MANAGEMENT  
 PROPOSALS

## BOWTHORPE ROAD SPEED MANAGEMENT SCHEME

## RESULTS OF PUBLIC CONSULTATION - AUGUST 2008

	ADDRESS	COMMENTS
1	96 Godric Place	<b>Objects</b> to the proposed double yellow lines outside the shop as this may cause the shop to close
2	63 Gipsy Lane	<b>Objects</b> to the proposed double yellow lines outside the shop as this may cause the shop to close
3	19 Kennedy Close	<b>Objects</b> to the proposed double yellow lines outside the shop as this may cause the shop to close
4	4 Gardyn Croft	<b>Objects</b> to the proposed double yellow lines outside the shop as this may cause the shop to close
5	45 Irstead Road	<b>Objects</b> to the proposed double yellow lines outside the shop as this may cause the shop to close
6	57 Winchcomb Road	<b>Objects</b> to the proposed double yellow lines outside the shop as this may cause the shop to close
7	15 Tollhouse Road	<b>Objects</b> to the proposed double yellow lines outside the shop as this may cause the shop to close
8	17 Fieldview	<b>Objects</b> to the proposed double yellow lines outside the shop as this may cause the shop to close
9	19 Irstead Road	<b>Objects</b> to the proposed double yellow lines outside the shop as this may cause the shop to close
10	45 Irstead Road	<b>Objects</b> to the proposed double yellow lines outside the shop as this may cause the shop to close
11	414 Dereham Road	<b>Objects</b> to the proposed double yellow lines outside the shop as this may cause the shop to close. The 2 lime trees outside the shop restrict visibility for traffic exiting Fieldview much more than parked vehicles.
12	1 Tollhouse Road	<b>Objects</b> to the proposed double yellow lines outside the shop as this may cause the shop to close.
13	25 Wrench Road	<b>Objects</b> to the proposed double yellow lines outside the shop as this may cause the shop to close. The 2 large tree outside the shop restrict the use of the forecourt and should be removed.
14	NORTH EARLHAM POST OFFICE, 308 Bowthorpe Road	<b>Objects</b> to the proposed double yellow lines outside the shop as this will reduce passing trade and may cause the shop to close. The Post Office part of the shop will close on 5th August and this will lose their main source of income. The 2 large tree outside the shop restrict the use of the forecourt and should be removed. There has never been an accident caused by traffic parked outside the shop, and the parked cars help to slow traffic down. It would also make deliveries more difficult.
15	57 Gipsy Lane East	<b>Objects</b> to the proposed double yellow lines outside the shop as this would affect passing trade may cause the shop to close.
16	89 Gipsy Lane	<b>Agrees</b> in principle to preventing traffic parking outside the shop, it does tend to slow the traffic down. Parking should be created on the shop forecourt. The proposed refuge will be of benefit as the road is difficult to cross.
17	533 Earlham Road	<b>Objects</b> to the proposed double yellow lines outside the shop as this may cause the shop to close.
18	10 Fieldview	<b>Objects</b> to the proposed double yellow lines outside the shop. The main problem is traffic speed. Parked vehicles help to slow the traffic down. The trees are the main restriction on visibility, and should be removed. The proposal is likely to put the shop out of business.

BOWTHORPE ROAD SPEED MANAGEMENT SCHEMERESULTS OF PUBLIC CONSULTATION - AUGUST 2008

	ADDRESS	COMMENTS
19	20 Ivy Road	<b>Objects</b> to the proposed double yellow lines outside the shop as this may cause the shop to close. The restriction would push parking into Gipsy Lane, Fieldview, Ivy Road etc. The access to the Tesco store at 5 ways should be looked at instead.
20	24 Earham Grove	<b>Objects</b> to the proposed double yellow lines outside the shop as this may cause the shop to close, and parking will be pushed elsewhere.
21	No address supplied	<b>Agrees</b> with the proposal for double yellow lines outside the shop and would like them to extend further. Vehicles parked close to the junction which restricts visibility when emerging from Fieldview. Also, pavement parking should be prevented with bollards.
22	4 Fieldview	Concerned about losing the shop. The trees should be removed to allow customers to park on the shop forecourt. Yellow lines need to be extended into Fieldview.
23	18 Ivy Road	<b>Objects</b> to the proposed double yellow lines outside the shop as this may cause the shop to close. Vehicles parked outside the shop help to slow the traffic down. The trees outside the shop are a much bigger hazard. The sight lines are also obscured when exiting Ivy Road
24	11 Fieldview	<b>Objects</b> to the proposed double yellow lines outside the shop as this may cause the shop to close. Parked vehicles do not restrict vehicles exiting Fieldview.
25	257 Robin Hood Road	<b>Objects</b> to the proposed double yellow lines outside the shop as this may cause the shop to close. The trees should be removed and the kerb dropped so that vehicles could park on the forecourt. The speed limit should be reduced to 20mph
26	326 Bowthorpe Road	<b>Objects</b> to the narrowing of the pavement outside their house as this would move traffic closer to the house and make visibility around the bend worse. Noise will increase and the likelihood of vehicles hitting their garden wall will increase.
27	53 Gipsy Lane	<b>Objects</b> to the proposed double yellow lines outside the shop as this may cause the shop to close.
28	10 Fieldview	<b>Objects</b> to the proposed double yellow lines outside the shop as this may cause the shop to close. Removal of parking will increase traffic speeds along Bowthorpe Road. The 2 trees outside the shop should be removed as these restrict visibility much more than parked cars. The proposed island would be safer located to the east of Gipsy Lane by the Cemetery Railings. An offset roundabout at the Ivy Road junction would be effective in slowing traffic, and also one by Gipsy Lane. The flashing sign should be located on the approach to the Fieldview junction
29	No address supplied	Agrees with the proposed yellow lines outside the shops as this will make it safer to turn right out of Fieldview. Cars regularly park on both sides of the Fieldview junction. These markings must be enforced by wardens. If not, a box junction would be preferred. Flashing signs are ignored by motorists. Speed cameras would be more effective. Road widening may encourage drivers to go faster. Approves of the cycle measures.
30	Colin Page, Police	<b>No objections</b>
31	17 Lusher Rise	<b>Objects</b> to the proposed double yellow lines outside the shop. This will result in cars parking further away creating more traffic problems, or parking in Fieldview

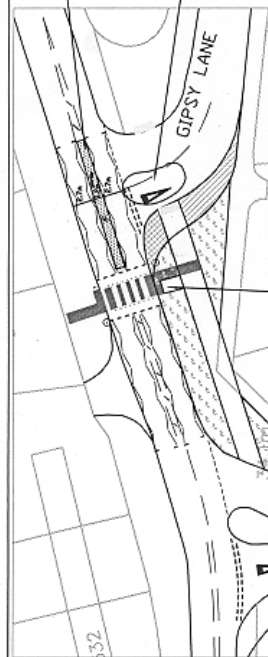
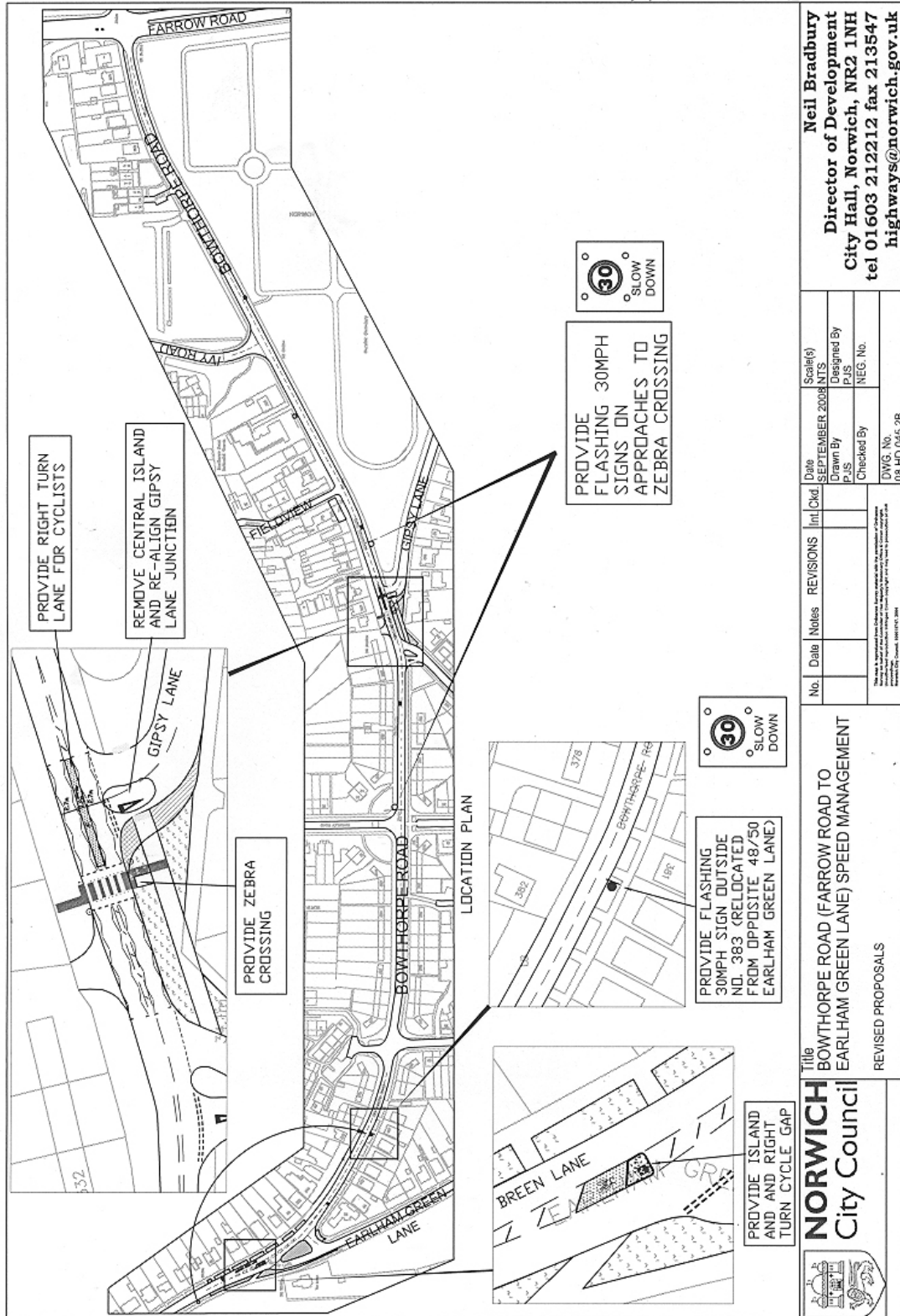

PROVIDE ZEBRA CROSSING



PROVIDE FLASHING 30MPH SIGN OUTSIDE NL 383 (RELOCATED FROM OPPOSITE 48/50 EARHAM GREEN LANE)

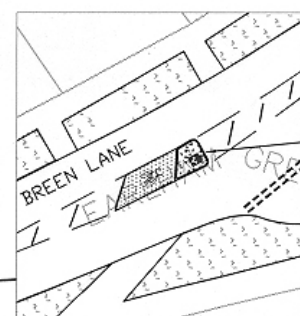

PROVIDE ISLAND AND RIGHT TURN CYCLE GAP

<b>NORWICH City Council</b>		<b>REVISOR PROPOSALS</b>	
<b>Title</b> BOWTHORPE ROAD (FARROW ROAD TO EARHAM GREEN LANE) SPEED MANAGEMENT		<b>Revised</b>	
<b>No.</b>	<b>Date</b>	<b>Notes</b>	<b>Revisions</b>
<b>Scale(s)</b>	<b>Date</b>	<b>Drawn By</b>	<b>Checked By</b>
<b>Scale(s)</b>	<b>Date</b>	<b>Drawn By</b>	<b>Checked By</b>
<b>Author</b> Neil Bradbury		<b>Designated By</b>	
<b>Director of Development</b>		<b>NEG. No.</b>	
<b>City Hall, Norwich, NR2 1NH</b>		<b>DWG. No.</b>	
<b>tel 01603 212212 fax 213547</b>		<b>08 HD 046 2B</b>	
<b>highways@norwich.gov.uk</b>			