**Norfolk** County Council
at your service

DRAWING TITLE

Push The Pedalsways Project 8
Park Lane/Unthank Road Essex Street
Shared Crossing Feasibility Layout

Tom McCabe
Interim Director of Environment,
Transport and Development
Norfolk County Council
County Hall
Martineau Lane
Norwich NR1 2SG

| REV. | DESCRIPTION | CHECKED | DATE |
|------|-------------|---------|------|
| | | | |
| | | | |
| | | | |
| | | | |

| | INIT. | DATE | DRAWING No. |
|-------------|-------|-------|-------------------------------|
| SURVEYED BY | PC | - | HI/NMAS/NS0039/001/ARW |
| DESIGNED BY | ARW | 07/14 | PROJECT TITLE |
| DRAWN BY | ARW | 07/14 | Push The Pedalsways Project 8 |
| CHECKED BY | TSY | 07/14 | SCALE 1: 250 |
| | | | FILE No. NS0039 |

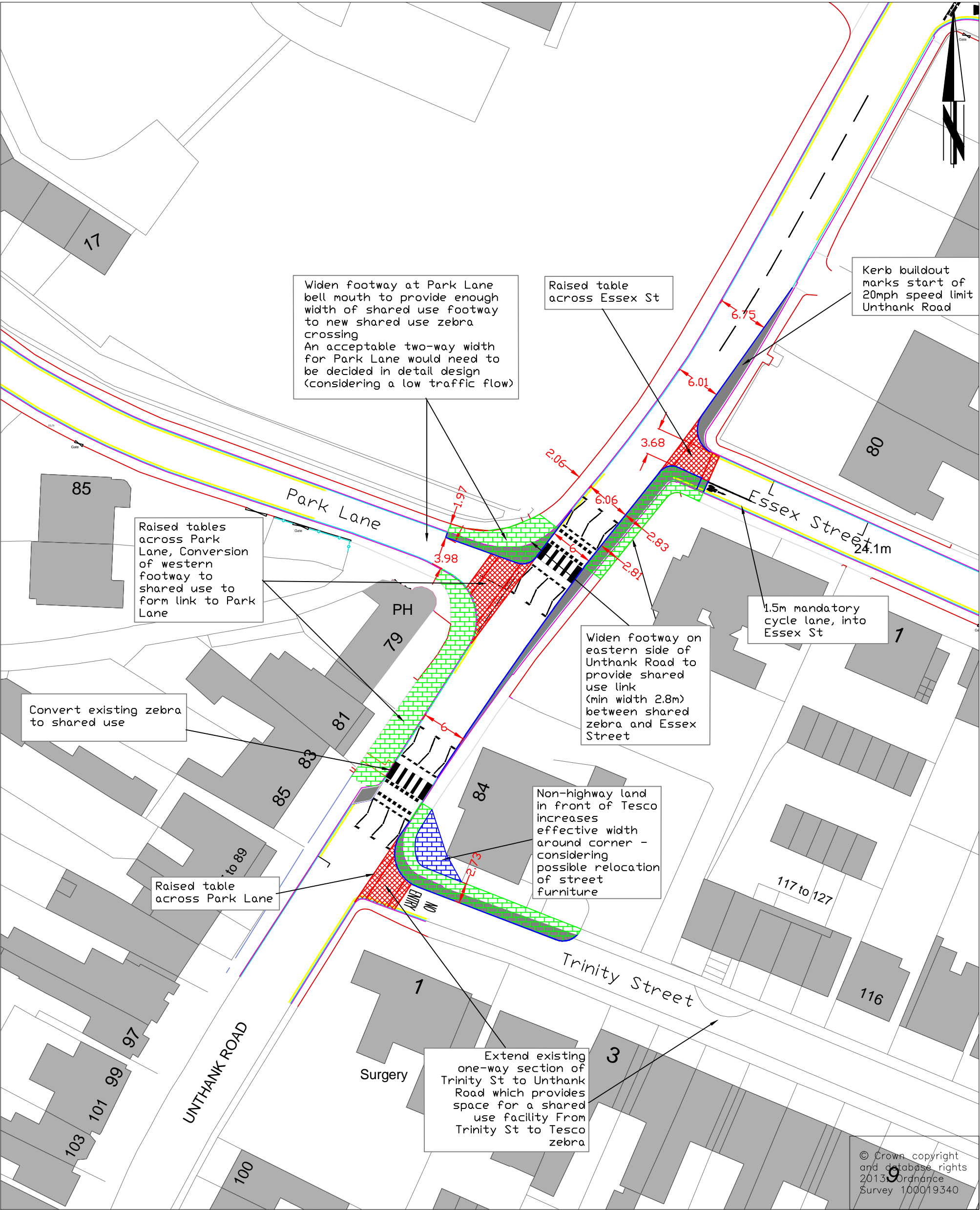

DRAWING TITLE

Push The Pedallways Project 8
Park Lane/Unthank Road/Essex Street
Essex Street/Trinity Street Gyratory Layout

Tom McCabe
Interim Director of Environment,
Transport and Development
Norfolk County Council
County Hall
Martineau Lane
Norwich NR1 2SG

| REV. | DESCRIPTION | CHECKED | DATE |
|------|-------------|---------|------|
| | | | |
| | | | |
| | | | |
| | | | |

| SURVEYED BY | INIT. | DATE | DRAWING No. |
|-------------|-------|-------|-------------------------------|
| | OS | - | HI/NMAS/NS0039/002/ARW |
| DESIGNED BY | ARW | 07/14 | PROJECT TITLE |
| | | | Push The Pedallways Project 8 |
| DRAWN BY | ARW | 07/14 | SCALE |
| | | | 1: 500 |
| CHECKED BY | TSY | 07/14 | FILE No. |
| | | | NS0039 |



NOTES

© Crown Copyright and database right 2011. Ordnance Survey 100019747.

REVISIONS

| No. | Date | Notes | Int. | Ckd. |
|-----|------|-------|------|------|
|-----|------|-------|------|------|

Title
**PARK LANE
ROAD CLOSURE**

STREET DESIGN OPTION TWO

Scale(s) 1:100

| | |
|------|----------|
| Date | DWG. No. |
|------|----------|

Designed by

Drawn By

| | |
|------------|--|
| Drawn By | |
| Checked By | |

Jerry Massey
Deputy Chief Executive
City Hall, Norwich, NR2 1NH
tel 0344 980 3333
pedalways@norwich.gov.uk



NOTES

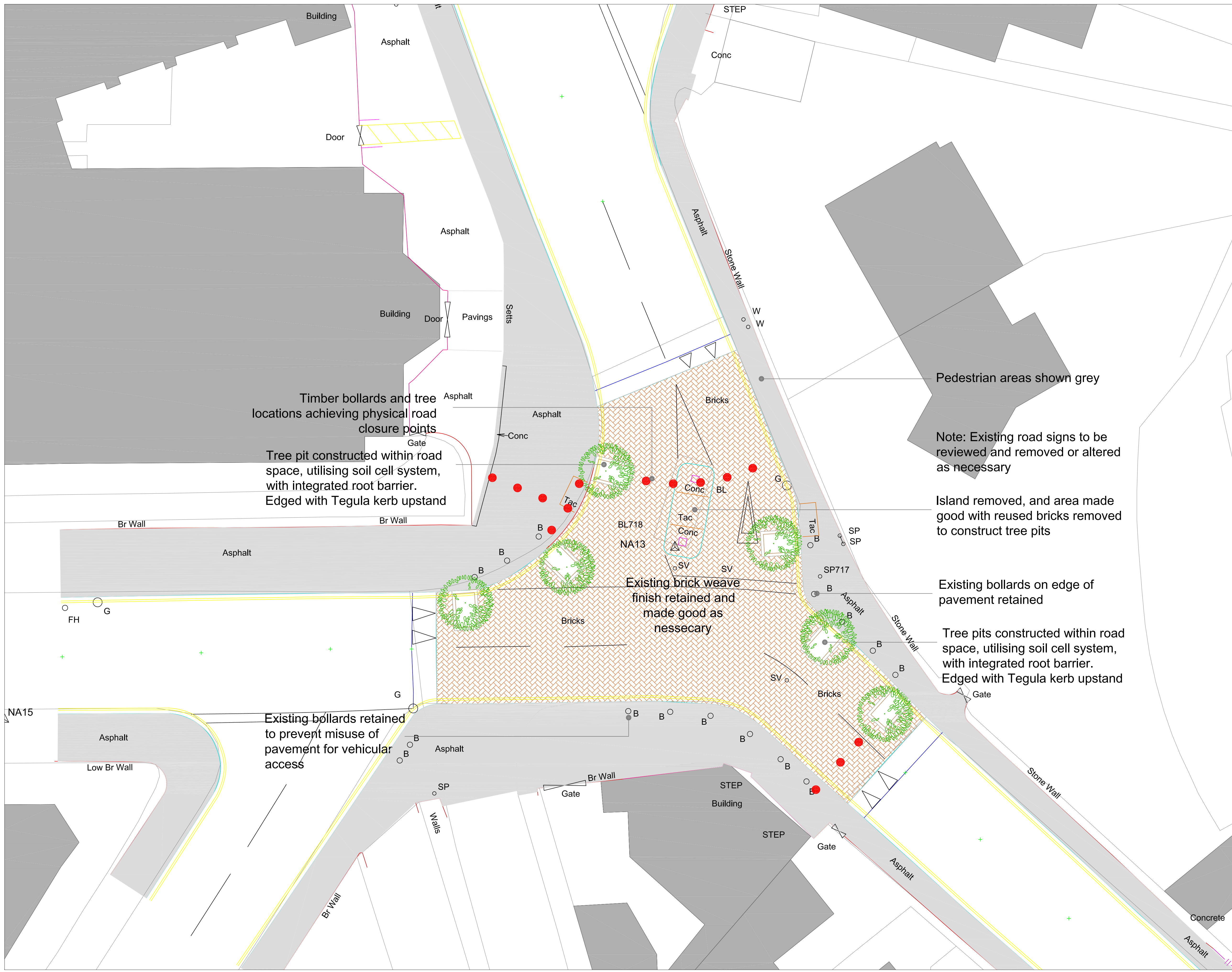

Timber bollards and tree locations achieving physical road closure points

Tree pit constructed within road space, utilising soil cell system, with integrated root barrier. Edged with Tegula kerb upstand

Pedestrian areas shown grey

Note: Existing road signs to be reviewed and removed or altered as necessary

Island removed, and area made good with reused bricks removed to construct tree pits

Existing bollards on edge of pavement retained

Tree pits constructed within road space, utilising soil cell system, with integrated root barrier. Edged with Tegula kerb upstand

Existing brick weave finish retained and made good as nessecary

Existing bollards retained to prevent misuse of pavement for vehicular access

© Crown Copyright and database right 2011. Ordnance Survey 100019747.

| REVISIONS | | | | |
|-----------|------|-------|------|------|
| No. | Date | Notes | Int. | Ckd. |
| | | | | |

Title
PARK LANE ROAD CLOSURE

STREET DESIGN
OPTION ONE

| | |
|----------------|----------|
| Scale(s) 1:100 | |
| Date | DWG. No. |
| Designed by | NEG. No. |
| Drawn By | |
| Checked By | |

Jerry Massey
Deputy Chief Executive
City Hall, Norwich, NR2 1NH
tel 0344 980 3333
pedalways@norwich.gov.uk